

Axtair One[®] Plus

Axtair Automorpho[®] Plus

Axtair Axensor[®] AT12/AT15/AT20

Axtair XXL[®]

Technical manual

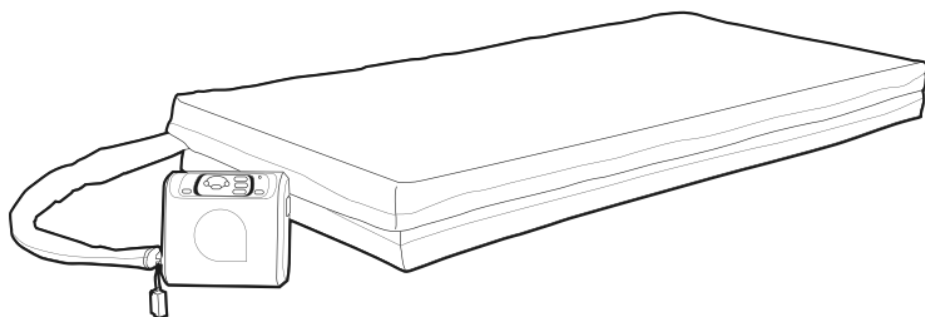







PA0010143
MAJ 28/11/2024

TABLE OF CONTENTS



| | |
|---|--------|
| ALARMS AND REPAIR | - 2 - |
| COMPRESSOR..... | - 4 - |
| MATTRESS | - 4 - |
| Maintenance diagram and recommended disinfection..... | - 8 - |
| PREVENTIVE MAINTENANCE..... | - 9 - |
| Servicing frequency:..... | - 9 - |
| Mattress..... | - 9 - |
| Compressor..... | - 9 - |
| AirCare solution | - 9 - |
| WEEE (Waste Electric and Electronic Equipment)..... | - 11 - |
| SPARE PARTS | - 12 - |
| Axtair One Plus compressor - Reference VAXT/POMPE/ONEP | - 12 - |
| Axtair Automorpho Plus compressor - Reference VAXT/POMPE/AUTOP | - 14 - |
| Axtair Automorpho Plus compressor - Reference VAXT/PAUTOP | - 16 - |
| Axtair One Plus compressor - Reference VAXT/PONEP | - 18 - |
| Axtair Axensor® compressor - Reference VAXT6/POMPE/AUTO..... | - 20 - |
| Axtair Axensor® compressor - Reference VAXT6/POMPE/AUTO-S | - 22 - |
| Axtair XXL compressor - Reference VAXT/POMPE/ XXL..... | - 24 - |
| Axtair One Plus mattress - Reference VAXT/MA/ONE | - 26 - |
| Axtair One Plus mattress - Reference VAXT/MONEP90/PUL or CIC | - 28 - |
| Axtair Automorpho Plus mattress - Reference VAXT/MA/AUTOP | - 30 - |
| Axtair Automorpho Plus mattress – Reference VAXT/MA/AUTOP100 | - 32 - |
| Axtair Automorpho Plus mattress – Reference VAXT/MA/AUTOP120 | - 34 - |
| Axtair Automorpho Plus mattress – Reference VAXT/MAUTOP90/PUH ou /CIC..... | - 36 - |
| Axtair Automorpho Plus mattress – Reference VAXT/MAUTOP100/PUH or CIC | - 38 - |
| Axtair Automorpho Plus mattress – Reference VAXT/MAUTOP120/PUH or CIC | - 40 - |
| Axtair Axensor® AT12 mattress – Reference VAXT6/MA/AUTO..... | - 42 - |
| Axtair Axensor® AT15 mattress – Reference VAXT6/MA/MAX | - 44 - |
| Axtair Axensor® AT20 mattress – Reference VAXT6/MA/AT20-90 | - 46 - |
| Axtair Axensor® AT20 - Reference VAXT6/MA/AT20-80 | - 48 - |
| Axtair XXL Mattress - Reference VAXT/MA/120XXL..... | - 50 - |
| Axtair XXL Mattress - Reference VAXT/MA/140XXL..... | - 52 - |

ALARMS AND REPAIR**Using the “info” key (Only on the Axtair Axensor pump)**

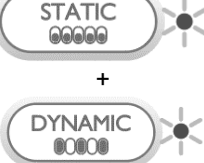
 A continuous press on this button when the compressor is running provides information about the last alarm recorded and the need for servicing.

| Alarm codes: Description | | Meaning |
|---|---------------------------------------|------------------------------|
|  | Lock indicator steady | System problem Support |
|  | Lock indicator flashing | Compressor system problem |
|  | Dynamic indicator flashing | No pressure |
|  | Treatment indicator steady | Initial inflation impossible |
|  | Treatment indicator flashing | Inflation impossible |
|  | Static indicator flashing | Over-pressure |
|  | Dynamic and static indicator flashing | Pneumatic problem |

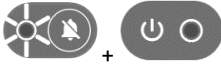
The following table shows all the alarms for the device, their triggering conditions, their priority as well as possible repair.

| Description | Trigger | | Possible repair |
|---|--|------------|--|
| | Condition | Time frame | |
| Alarm indicator flashing and mains indicator off OFF  + sound signal | Electrical fault: the compressor is not powered by the mains | 0 min | 1 - Re-connect the compressor 2 - Check the status of the electricity network 3 - Replace the fuse |
| Alarm indicator flashing and mains indicator on ON  + sound signal | Compressor system problem | 0 to 1 min | 1 - Check that the mattress is properly connected to the compressor 2 - Check that the CPR valve is well sealed 3 - Check the leak-tightness of the mattress |
| | The compressor measures a nil pressure when pumping | 1 min | |
| | The compressor measures an over-pressure | 1 min | |
| | Inflation impossible | 10 min | |
| | The compressor detects a pneumatic problem | 1 min | |
| Alarm indicator steady  + sound signal | Initial inflation impossible | 40 min | 1 - Check that the mattress is properly connected to the compressor 2 - Check the status of the AXENSOR® box 3 - Check that the CPR valve is well sealed 4 - Check the leak-tightness of the mattress |
| | Support system problem | 0 min | |

For any other repair solution, contact your retailer or if you are trained, use the AirCare solution.

COMPRESSOR

- **INDICATIONS:** Use a cloth soaked in a detergent product solution or CE* labelled surface detergent/disinfectant at the use concentrations recommended by the manufacturer. Adhere to the remanence times.

- **CONTRAINDICATIONS:** 

It is essential to disconnect the power cord connected to the compressor from the mains power outlet. The "mains" indicator must be off.





- Do not use a high-pressure jet to clean an AXTAIR line compressor.
- Do not spray liquid to avoid any damage to the compressor by penetration of liquid inside the box.

- **PRECAUTIONS:** 

Do not use abrasive cleaning products such as industrial detergents, acetone type solvents, ether and coloring products (iodized alcohol, potassium permanganate, silver nitrate etc.). Do not allow abrasive materials such as steel wool or "scotch brite" pads.

MATTRESS

Depending on the type of mattress, there are several cleaning options available:





| | Manual disinfection | Domestic washing barrier | Machine barrier aseptic | REHAWASH process |
|---------------------------|---|---|---|--|
| Type of disinfection | Manual disinfection  | Covers only  | Complete mattress  | Complete mattress  |
| Mattress One Plus* | ✓ | ✓ | ✓ | ✓ |
| Mattress Automorpho Plus* | ✓ | ✓ | ✓ | ✓ |
| Mattress Axensor | ✓ | ✓ | | ✓ |
| Mattress XXL | ✓ | ✓ | | |

* marketed from 01/11/2022

All mattresses in the Axtair range are designed with a pneumatic assembly (Cells + Bundle + Maintaining Sheet) that can be easily removed from the base for easy cleaning and machine washing of the textile components.

For AXENSOR® mattresses, the AXENSOR® pneumatic unit and control box must be manually disinfected: use a cloth soaked in a detergent solution or CE* labelled surface detergent/disinfectant at the use concentrations recommended by the manufacturer (Adhere to the remanence times) or follow the washing protocol of the REHAWASH process.

The covers and the bases can be machine washed in the following conditions:

| | |
|---|---|
|  | Machine wash, maximum temperature 90°C, reduced mechanical action, rinsing at decreasing temperature, reduced spinning. |
|  | Maximum allowable chlorine concentration of 5000 ppm. |
|  | Do not iron. |
|  | Do not dry clean. |
|  | Trumble dry on low heat, moderate temperatures (60°C). |

Aseptic Barrier Machine Washing: One Plus and Automorpho Plus mattresses marketed since 01/11/2022 are compatible with barrier machine disinfection.

For more information, please refer to the protocol sheet F039, presented in the following pages.

HELP WITH EQUIPMENT
MAINTENANCE

SHEET 039

26/09/2024

AXTAIR MATTRESS ASEPTIC BARRIER MACHINE



PURPOSE

Complete washing of the Axtair One Plus and Automorpho Plus mattresses in an aseptic barrier machine to prevent the transmission of germs from one patient to another by thermal action. Full washing ensures that the mattress is physically and microbiologically clean.

EPI



INDICATIONS

Each time that the product is returned ,
and between each patient.



EQUIPMENT

- ▶ Professional aseptic barrier washing machine with disinfectant detergent,
- ▶ Professional tumble dryer,
- ▶ Washing bag.



PROTOCOL

axtair one[®]
plus

1. Open the cover at the 3 sides and remove the holding sheet - beam - cells assembly using the 2 zips,
2. Remove the foam base,
3. Close the pneumatic connector of the mattress using its transport cap,
4. Roll without tightening the holding sheet with the cells inward. Put this set in the washing net, closing it with the connector,
5. Insert the washing net and cover into the washing machine,
6. After the spin cycle, put the washing net and cover in the dryer,
7. After it is completely dry, assemble the mattress and check that it is working properly by inflating it with a quick inflation pump. Check the correct positioning of the cells,
8. Then pack the mattress into a clean transport bag for storage and delivery.

axtair automorpho[®]
plus

1. Unzip the top cover,
2. Remove the holding sheet - beam - cells using the 2 zips,
3. Open the bottom antislip base and remove the foam base,
4. Close the pneumatic connector of the mattress using its transport cap,
5. Verify that the pressure relief of the heel valves are in the open position (*discharge not activated*),
6. Roll without tightening the holding sheet with the cells inward. Put this set in the washing net, closing it with the connector,
7. Insert the washing net, base and top cover into the washing machine,
8. After the spin cycle, put the washing net, base and cover in the dryer,
9. After it is completely dry, assemble the mattress and check that it is working properly by inflating it with a quick inflation pump. Check the correct positioning of the cells,
10. Pack the mattress into a clean transport bag for storage and delivery.



SETTINGS¹

Barrier washing machine

- ▶ 60°C < washing temperature < 65°C (*provides thermal disinfection¹ without cell degradation or disconnection*),
- ▶ Maximum spin speed² < 750 RPM,
- ▶ Duration: at a temperature of 65°C the washing time must be more than 25 minutes and is calculated using the following formula³:

$$\sum mi (Ti-55) > 250^3$$

With $\sum mi$ = number of minutes during which the temperature in °C is maintained

Ti = washing temperature in °C

The number of mattresses that can be washed at the same time depends on the capacity of the machine. Example: a 22 kg machine allows you to wash 4 mattresses.

Dryer

- ▶ 50°C < drying temperature < 65°C
- ▶ Minimum to get proper drying: 48 minutes at a temperature of 65°C



IMPORTANT

- ▶ A dryer is essential to ensure proper drying of the mattress and good microbiological quality of the device (*all parts of the mattress must be completely dry before repackaging*).
- ▶ The hold sheet - harness - cells set shall remain in the washing net when drying.
- ▶ The machine must be loaded as per the manufacturer's instructions for optimum efficiency of the washing and drying cycles and to avoid degradation.

¹ RABC Protocol according to the standard NFEN 14065 December 2016.

² Maximum spin speed. It may be necessary to reduce it according to the make of machine used. The tests were carried out on FAGOR machines.

³ Recommendation of the Conseil Supérieur d'Hygiène du Service Public Fédéral de la Santé de Belgique [Superior Council of Hygiene of the Federal Public Health Service of Belgium.]

MAINTENANCE DIAGRAM AND RECOMMENDED DISINFECTION

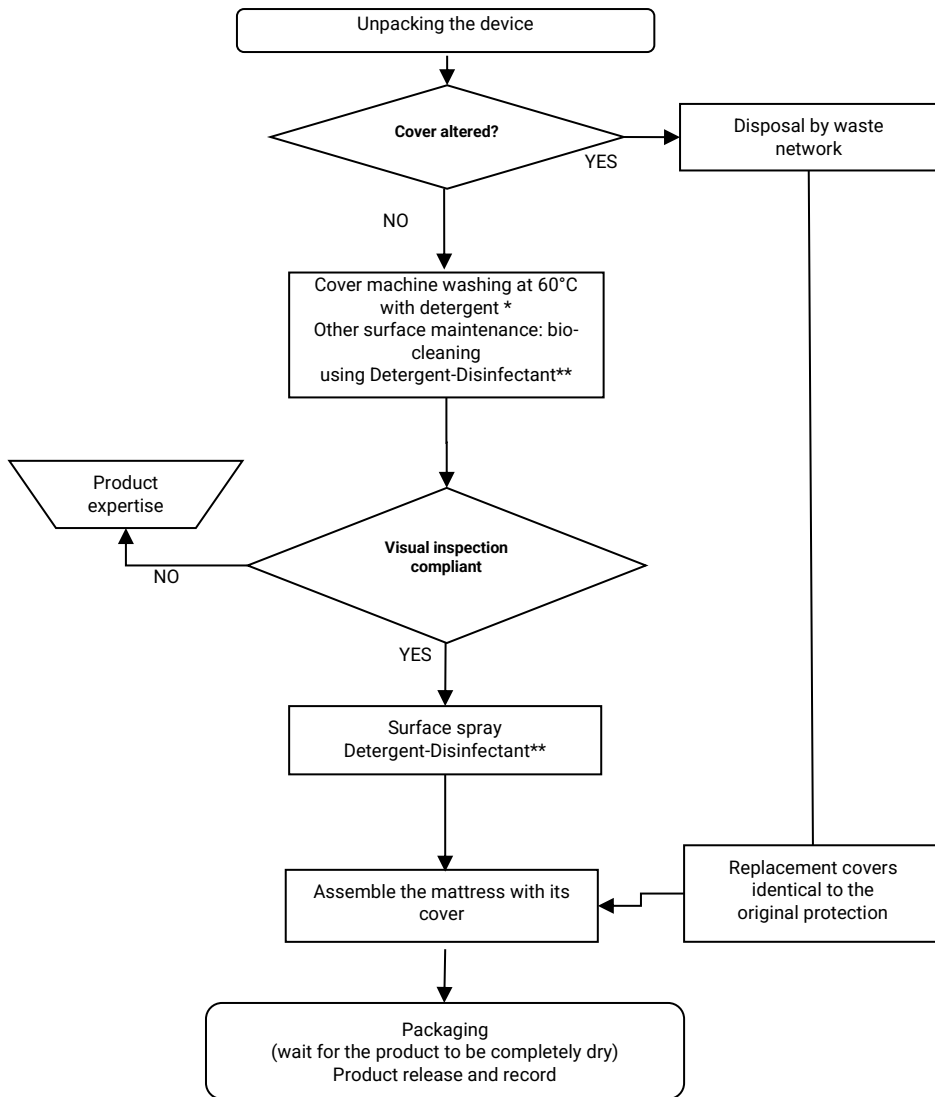

* Neutral detergent (household washing product)

** Wide spectrum cleaning disinfectant product, compliant with standards Bactericide EN1040, EN13727+A2; Fungicide EN1275, EN13624; Sporicide EN14347; Virucide EN 14476+A2.

PREVENTIVE MAINTENANCE

SERVICING FREQUENCY:

It is recommended to service the compressors and mattresses at least every 2 years of use for the following product:

- AXTAIR ONE® PLUS
- AXTAIR AUTOMORPHO® PLUS
- AXTAIR AXENSOR®
- AXTAIR XXL®

MATTRESS

Top cover: visually inspect for damage and stains on the stitch side (white). If damage or stains are found, the cover must be replaced.

AXTAIR mattresses do not contain any wear parts. A simple check of leak-tightness is recommended at the time of servicing.

Steps for checking mattress leak-tightness:

1. Inflate the mattress to a pressure between 85mBar and 100mBar.
2. Wait for the pressure to stabilize for approximately 30 seconds
3. Record the exact pressure of the mattress (P0)
4. Wait 1 minute and record the new pressure (P1)
5. The mattress is deemed to be compliant with the leak-tightness test if the difference between P0 and P1 (P0-P1) is less than or equal to 5 mBar.

In the event of non-conformity, it is necessary to identify the failing components (cells, connection, CPR valve etc.) and to replace them with components provided by the manufacturer. After replacement a further leak-tightness test should be performed.

COMPRESSOR

The filter of the compressor must be replaced once per year or more frequently depending on environmental conditions (dust, smoke, etc.).

This filter is on the back of the compressor behind a transparent card which shows its level of fouling. (The original filters are white)

AXTAIR compressors contain wearing parts that need to be replaced and a sensor that needs to be checked for calibration.

Tightening torque / Screws:

When carrying out maintenance on AXTAIR compressors, we recommend a tightening torque of 0.8 Nm on all compressor screws. Using a torque other than that recommended by the manufacturer could, among other things, lead to damage to the shell chimneys.

WINNCARE France recommends the use of a torque screwdriver, type FIRSTINFO H5178, with a range of 0.1 to 1.2 Nm, and high precision for the 0.8 Nm value. This screwdriver is available for purchase from our after-sales service (ref: WS/01/0097).

AIRCARE SOLUTION



The AirCare solution was developed for the preventive and curative maintenance of these systems. Access to the solution requires:

- Following a specific one-day training session. Training module: WS/FORM/05. The detailed program and dates for this training are available on winncare.fr on the training tab. This training is also available as e-learning.
- Downloading specific software running in a Windows environment.
- The purchase of a connection kit containing the control tools.

The AirCare solution authorizes preventive and curative maintenance operations on the compressors and mattresses. The software is used for:

- quick troubleshooting of the checked system,
- the validation of servicing operations with removal of the maintenance key,
- repair validation,
- the traceability of all completed operations.

It is possible to find out if Axtair Axensor compressor servicing is required by a continuous press on the  button when the compressor is running.

| Coding for servicing requirement: Description | | Meaning |
|---|----------------------------|--|
|  | Hourglass flashing quickly | Servicing date exceeded. Servicing to be scheduled. |
|  | Hourglass steady | No need for servicing. |

For AXTAIR ONE® PLUS / AXTAIR AUTOMORPHO® PLUS / AXTAIR XXL® compressors:
The "spanner" icon LED lights on the compressor to indicate that servicing is required.

| Servicing required | | Meaning |
|---|-----------|---|
|  | FIXED LED | Means product servicing is required (17500 hours of operation). |

Servicing compressors at least every 2 years of use is recommended.

To facilitate the management and scheduling of this servicing, counters give information about compressor use and the time since last servicing. This information is available using the AirCare maintenance software.

⚠ WARNING:

Servicing can only be carried out authorized persons, **contact your dealer or the manufacturer.**

WEEE (WASTE ELECTRIC AND ELECTRONIC EQUIPMENT)

In compliance with applicable regulations covering the elimination of Waste electric and electronic equipment (WEEE), Winncare France is committed to contributing to the processing and recycling of electric and electronic equipment at the end of its service life.

The holder must never dispose of electric and electronic equipment at the end of its service life in the environment or with household waste with other unsorted waste, so that it can be the subject of selective collection in order to be recycled or reused in order to protect the environment, protect natural resources and protect health.

EQUIPMENT CONCERNED

The devices and instruments that feature the symbol  (Waste electric and electronic equipment) meaning that at the end of their service life they must not be mixed with other types of waste, must be the subject of separate processing.

BEFORE 13 AUGUST 2005: FOR ELECTRIC AND ELECTRONIC EQUIPMENT PUT ON THE MARKET

Holders must finance and organize the elimination of electric and electronic equipment at the end of its service life themselves. Unless the equipment is replaced by an equivalent device or a device that has the same function. In that case, Winncare France applies the same waste electric and electronic equipment (WEEE) elimination procedure as for equipment put on the market after 13 August 2005.

AFTER 13 AUGUST 2005: FOR ELECTRIC AND ELECTRONIC EQUIPMENT PUT ON THE MARKET

Winncare France complies with applicable European regulations. Winncare France undertakes to finance and organize the elimination of such waste.

The procedures for the organization and elimination of WEEE are available from:

WINNCARE France

4 LE PAS DU CHÂTEAU

85670 SAINT PAUL MONT PENIT

email: contact@winncare.fr or on our website: www.winncare.com

If the holder does not apply this procedure, they must recycle electric and electronic equipment at the end of its service life using an adapted method and at their own expense. They must communicate the necessary information to Winncare France.

If the products are re-sold, the holder must make sure the new owner is perfectly informed of their duties in terms of recycling electric and electronic equipment at the end of its service life.

SPARE PARTS

A list of spare parts is available from WINN CARE France after-sales service:

Mail: sav@winn care.fr

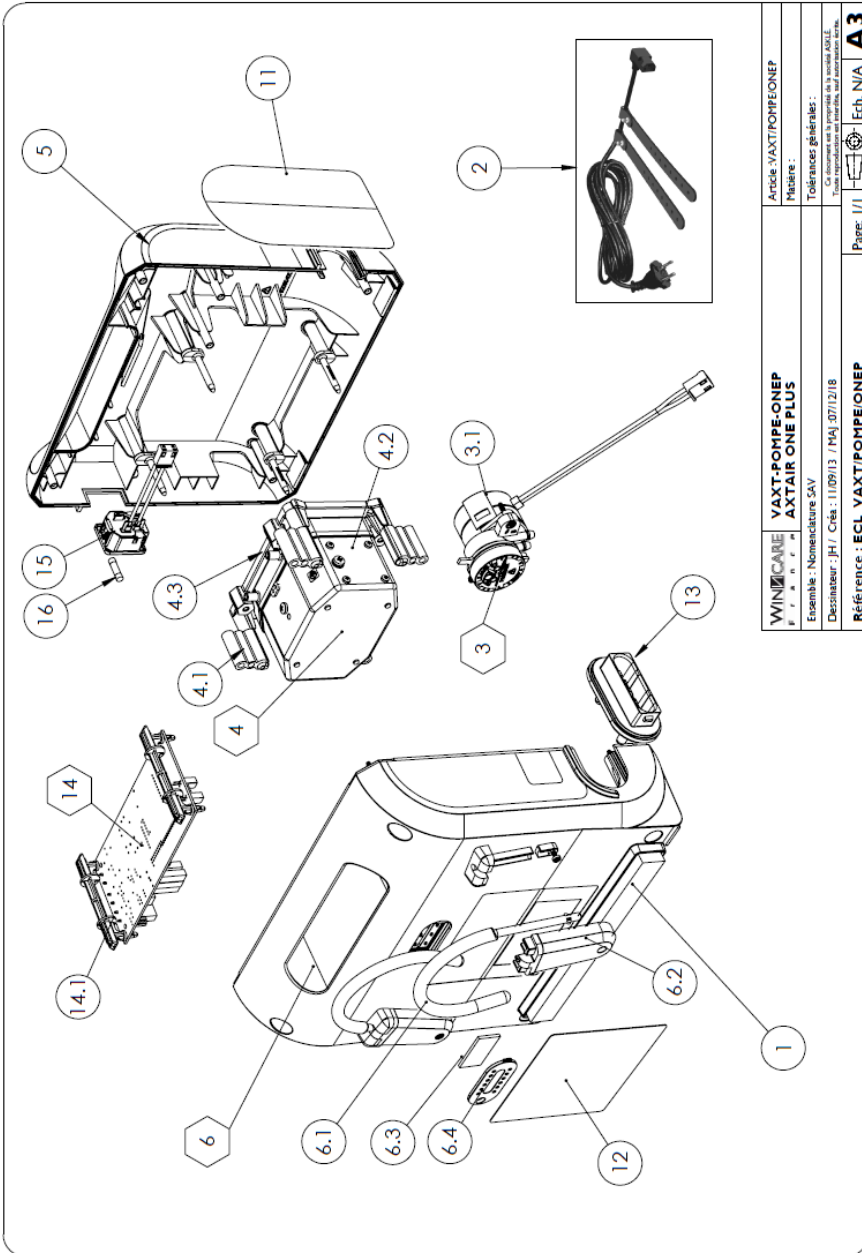
AXTAIR ONE PLUS COMPRESSOR - REFERENCE VAXT/POMPE/ONEP

| | | |
|--|-----------------------------|--|
| WINN CARE F r a n c e | VAXT-POMPE-ONEP | Article: VAXT/POMPE/ONEP |
| | AXTAIR ONE PLUS | Titulaire : |
| | Ensemble : Nomenclature SAV | Traitement généraliste : |
| Dispositif : JH / Créa : 11/09/13 / MAJ : 07/12/18 | | Si une modification est apportée au modèle, la référence doit être actualisée. |
| Référence : ECL_VAXT/POMPE/ONEP | | Ech. N/A A3 |
| | | Page: 1/1 |

List of references: VAXT/POMPE/ONEP

| Rep. | Before | | After ** | |
|------|--|-------------|------------|--|
| | References | References | References | Designation |
| 1 | PB2050521 | | | Self-adhesive isophonic foam |
| 2 | PB2050163 | | | Power cord & clips |
| 3 | WS/01/0073* | | | Air distributor assembly |
| 3.1 | PB2050118* | | | Motor 0.83RPM CW+ connections |
| 4 | WS/01/0074* | | | Pump assembly |
| 4.1 | PB2050127* | | | Silentbloc |
| 4.2 | PB2050135* | | | Air pump |
| 4.3 | PB2050126* | | | Pump support |
| 5 | WS/01/0083* | WS/01/0084* | | Front shell assembly |
| 6 | WS/01/0076* | WS/01/0087* | | Rear shell assembly |
| 6.1 | PB2050171 | | | Fixing hook |
| 6.2 | PB2050140 | PB2050343 | | Fixing bracket hook |
| 6.3 | PB2050136 | | | air filter |
| 6.4 | PB2050139 | | | Filter cover |
| 11 | references depend on the language of your country*** | | | |
| 12 | PB2050146 | PB2050530 | | Rear Sticker |
| 13 | PB2050210* | | | Female Connector |
| 14 | WS/01/0081* | | | Electronic PCB+ support x 2 |
| 14.1 | PB2050138* | | | PCB support |
| 15 | PB2050153* | | | 230 volt female connector |
| 16 | PB2050154* | | | Ceramic Fuse 5x20 |
| // | PB2050337* | | | Single-dose grease |
| // | VAXT/KITREV01* | | | Overhaul kit (all components required for the standard AirCare overhaul) |

* The use of these references requires the completion of AirCare training.

** Compatible references if the serial number is **higher** than

- 18458140 (VAXT/POMPE/AUTOP)

- 18457072 (VAXT/POMPE/ONEP)

- 18455241 (VAXT6/POMPE/AUTO)

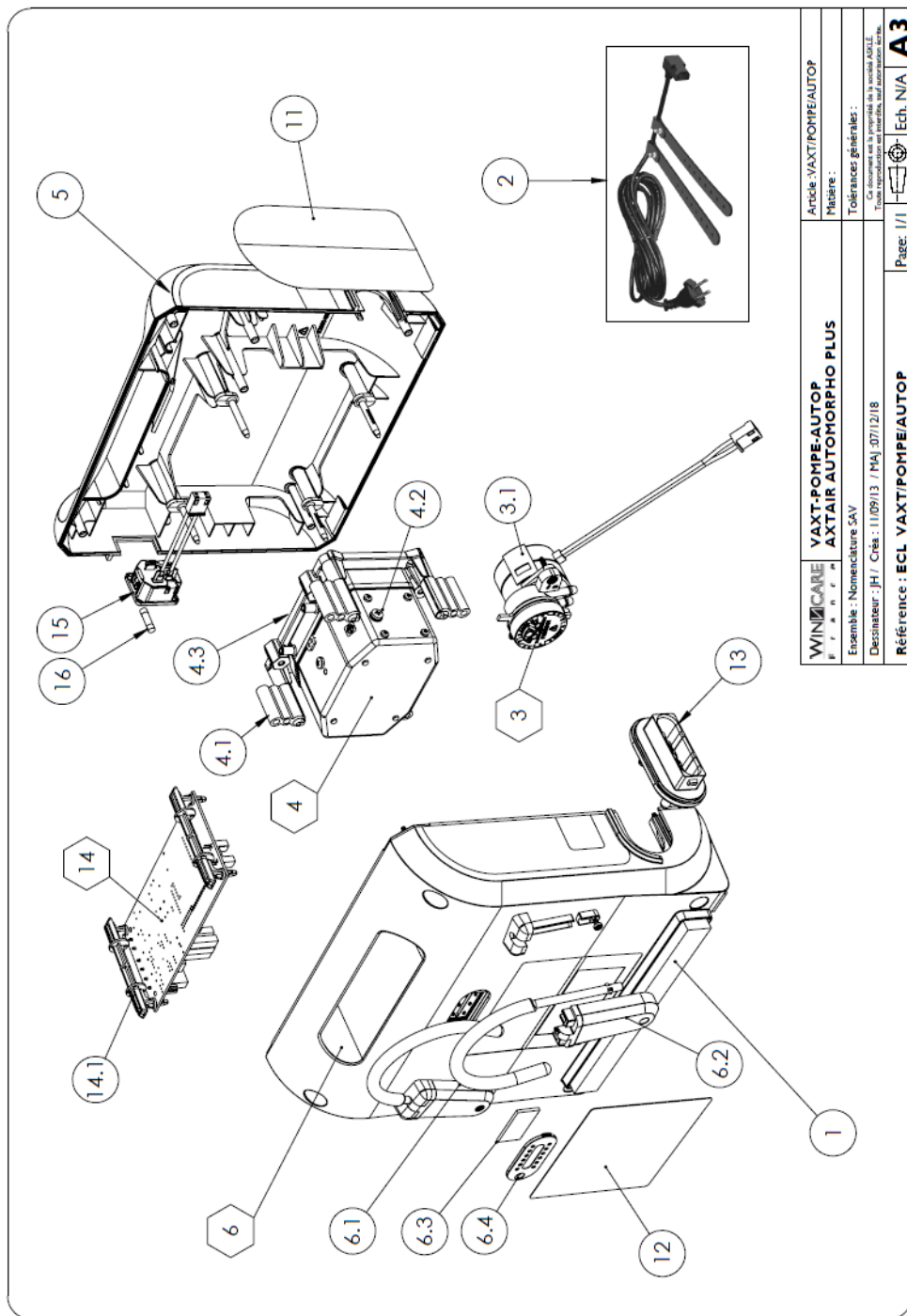

| | | |
|---|--|---|
| WINNCARE | VAXT-POMPE-AUTOP Axtair AUTOMORPHO PLUS | Article : VAXT/POMPE/AUTOP |
| Ensemble : Nomenclature SAV | | Matériau : |
| Destinataire : JH / Cds : 11/09/13 / MAJ : 07/12/18 | | Tolérances générales : |
| Dispositif : JH / Cds : 11/09/13 / MAJ : 07/12/18 | | Ca. document est le propriété de la société AXALE. Tous droits réservés. Toute réimpression, sans autorisation écrite. |
| Référence : ECL_VAXT/POMPE/AUTOP | | Page: 1/1 |
| | | Ech. N/A A3 |

| Rep. | Before | | After ** | | Designation |
|------|---|--|-------------|--|--|
| | References | | References | | |
| 1 | PB2050521 | | | | Self-adhesive isophonic foam |
| 2 | PB2050163 | | | | Power cord & clips |
| 3 | WS/01/0073* | | | | Air distributor assembly |
| 3.1 | PB2050118* | | | | Motor 0.83RPM CW+ connections |
| 4 | WS/01/0074* | | | | Pump assembly |
| 4.1 | PB2050127* | | | | Silentbloc |
| 4.2 | PB2050135* | | | | Air pump |
| 4.3 | PB2050126* | | | | Pump support |
| 5 | WS/01/0077* | | WS/01/0085* | | Front shell assembly |
| 6 | WS/01/0076* | | WS/01/0087* | | Rear shell assembly |
| 6.1 | PB2050171 | | | | Fixing hook |
| 6.2 | PB2050140 | | PB2050343 | | Fixing bracket hook |
| 6.3 | PB2050136 | | | | air filter |
| 6.4 | PB2050139 | | | | Filter cover |
| 11 | references depend on the language of your country | | | | Axtair side sticker |
| 12 | PB2050146 | | PB2050530 | | Rear Sticker |
| 13 | PB2050210* | | | | Female Connector |
| 14 | WS/01/0081* | | | | Electronic PCB+ support x 2 |
| 14.1 | PB2050138* | | | | PCB support |
| 15 | PB2050153* | | | | 230 volt female connector |
| 16 | PB2050154 | | | | Ceramic Fuse 5x20 |
| // | PB2050337* | | | | Single-dose grease |
| // | VAXT/KITREV01* | | | | Overhaul kit (all components required for the standard AirCare overhaul) |

* The use of these references requires the completion of AirCare training.

** Compatible references if the serial number is **higher** than :

- 18458140 (VAXT/POMPE/AUTOP)

- 18457072 (VAXT/POMPE/ONEP)

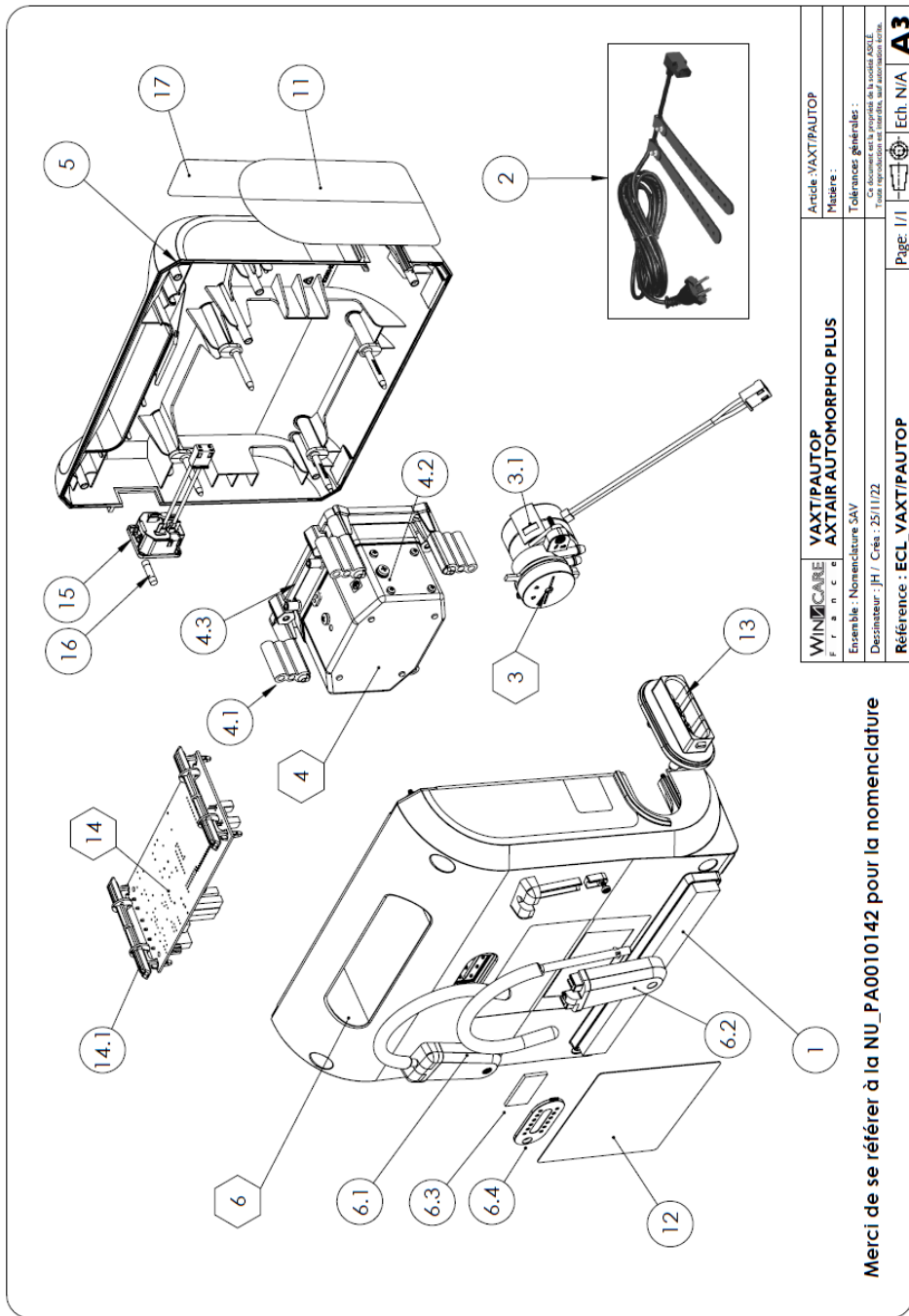

| | | |
|-----------------------------------|---------------------------------------|---|
| WINNCARE F r a n c e | VAXT/PAUTOP AXTAIR AUTOMORPHO PLUS | Article : VAXT/PAUTOP |
| | Espace : Nomenclature : SAV | Matière : |
| Description : JH / Cds : 25/11/22 | | Tolérances générales : |
| Référence : ECL_VAXT/PAUTOP | | Tous droits réservés en matière de brevets, sauf autorisation écrite. |
| | | Page: 1/1 |
| | | Ech: N/A |
| | | A3 |

Merci de se référer à la NU_PA0010142 pour la nomenclature

List of references: VAXT/PAUTOP

| Rep. | References | Designation |
|------|--------------------------|--|
| 1 | PB2050521 | Self-adhesive isophonic foam |
| 2 | PB2050163 | Power cord & clips |
| 3 | WS0100073* | Air distributor assembly |
| 3.1 | PB2050118* | Motor 0.83RPM C/w+ connections |
| 4 | WS0100074* | Pump assembly |
| 4.1 | PB2050127* | Silentbloc |
| 4.2 | PB2050135* | Air pump |
| 4.3 | PB2050126* | Pump support |
| 5 | WS0100085* | Front shell assembly |
| 6 | WS0100087* | Rear shell assembly |
| 6.1 | PB2050171 | Fixing hook |
| 6.2 | PB2050343 | Fixing bracket hook |
| 6.3 | PB2050136 | air filter |
| 6.4 | PB2050139 | Filter cover |
| 11 | references depend on the | Axair side sticker |
| 12 | PB2050530 | Rear Sticker |
| 13 | PB2050532* | Female Connector |
| 14 | WS0100081* | Electronic PCB+ support x 2 |
| 14.1 | PB2050138* | PCB support |
| 15 | PB2050153* | 230 volt female connector |
| 16 | PB2050154 | Ceramic Fuse 5x20 |
| 17 | PB2050553 | QR CODE Sticker |
| // | PB2050337* | Single-dose grease |
| // | VAXTKITREV01* | Overhaul kit (all components required for the standard AirCare overhaul) |

* The use of these references requires the completion of AirCare training.

•••
 PB2050566 = GB PB2050575 = IT PB2050584 = PT
 PB2050569 = DE PB2050578 = NL PB2050587 = DK
 PB2050572 = ES PB2050581 = PL PB2050590 = SK

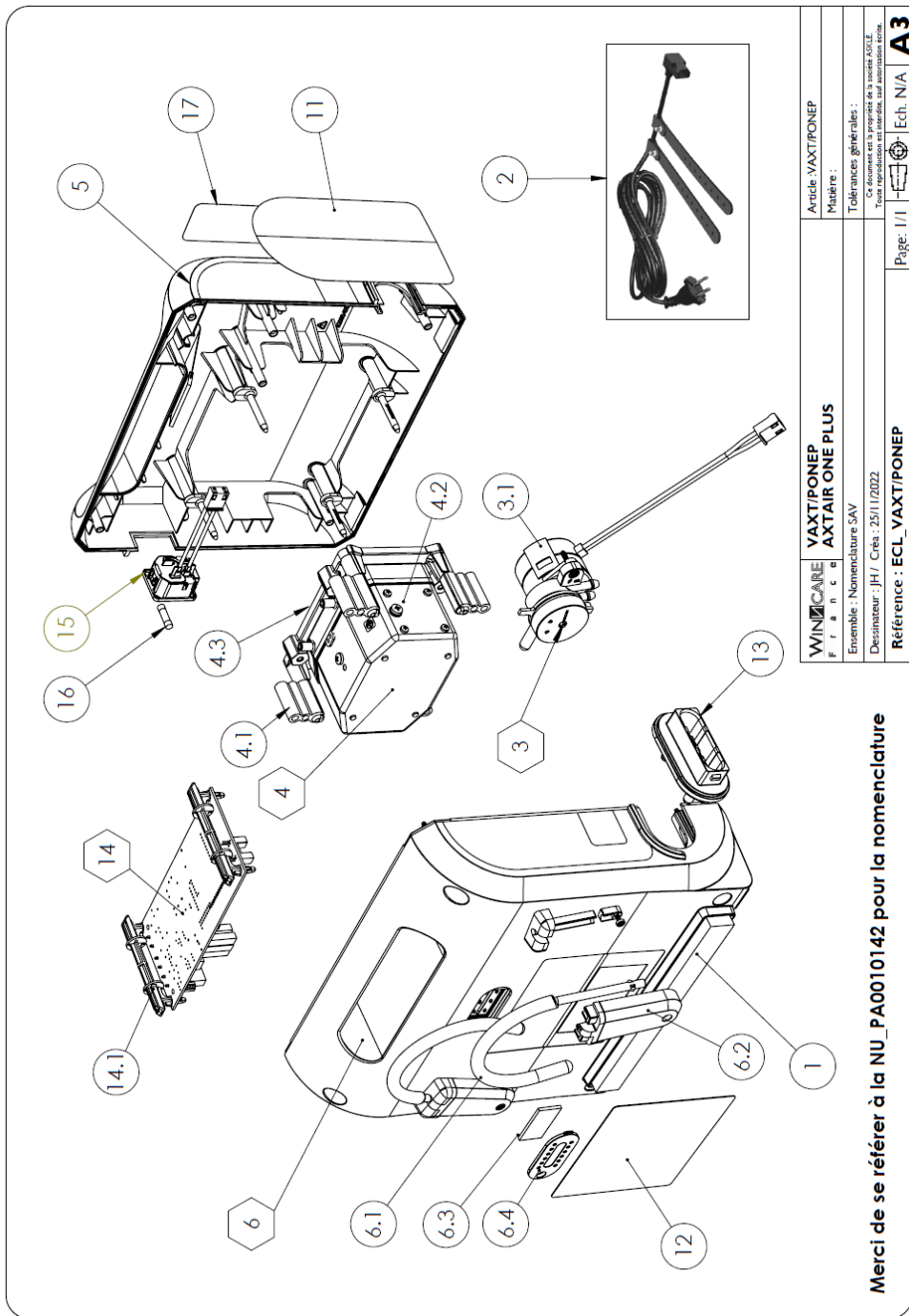

| | | |
|--------------------------------------|--------------------------------------|---|
| WINNOCARE F r a n c e | VAXT/PONEP AXTAIR ONE PLUS | Article : VAXT/PONEP |
| Ensemble : Nomenclature SAV | | Matériau : |
| Destinateur : JH / Créa : 25/11/2022 | | Tolérances générales : |
| Référence : ECL_VAXT/PONEP | | Tous les composants sont fournis en association avec. |
| Page : 1/1 | | Ech. : N/A A3 |

Merci de se référer à la NU_PA0010142 pour la nomenclature

List of references: VAXT/PONEP

| Rep. | References | Designation |
|------|---|--|
| 1 | PB2050521 | Self-adhesive isophonic foam |
| 2 | PB2050163 | Power cord & clips |
| 3 | WS/01/0073* | Air distributor assembly |
| 3.1 | PB2050118* | Motor 0.83RPM CW+ connections |
| 4 | WS/01/0074* | Pump assembly |
| 4.1 | PB2050127* | Silentbloc |
| 4.2 | PB2050135* | Air pump |
| 4.3 | PB2050126* | Pump support |
| 5 | WS/01/0084* | Front shell assembly |
| 6 | WS/01/0087* | Rear shell assembly |
| 6.1 | PB2050171 | Fixing hook |
| 6.2 | PB2050343 | Fixing bracket hook |
| 6.3 | PB2050136 | air filter |
| 6.4 | PB2050139 | Filter cover |
| 11 | references depend on the language of your country*** | Side Sticker Axtair |
| 12 | PB20503530 | Rear Sticker |
| 13 | PB2050532* | Female Connector |
| 14 | WS/01/0081* | Electronic PCB+ support x 2 |
| 14.1 | PB2050138* | PCB support |
| 15 | PB2050153* | 230 volt female connector |
| 16 | PB2050154* | Ceramic Fuse 5x20 |
| 16 | PB2050553 | Sticker QR CODE |
| // | PB2050337* | Single-dose grease |
| // | VAXT/KITREV01* | Overhaul kit (all components required for the standard AirCare overhaul) |

* The use of these references requires the completion of AirCare training.

*** PB2050566 = GB PB2050575 = IT PB2050584 = PT

PB2050569 = DE PB2050578 = NL PB2050587 = DK

PB2050572 = ES PB2050581 = PL PB2050590 = SK

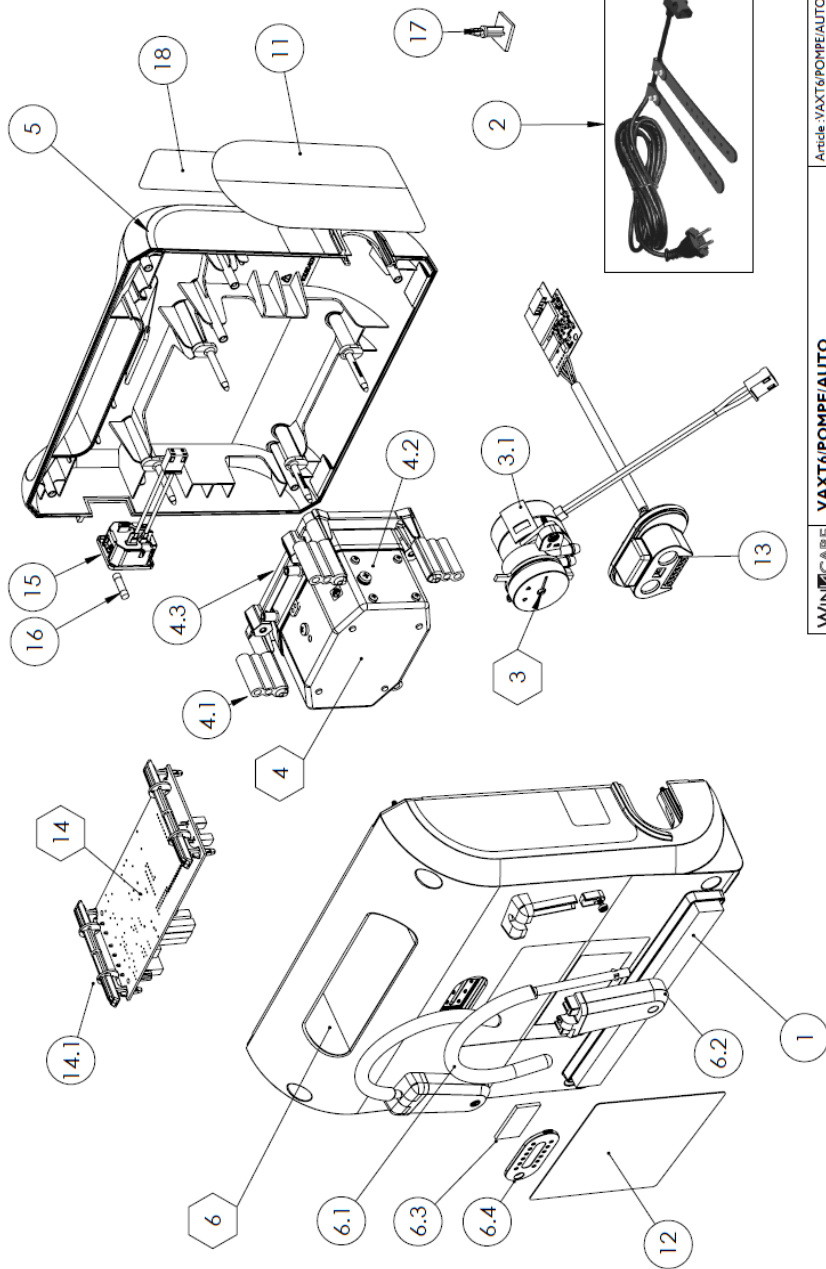

Merci de se référer à la NU_PA0010142 pour la nomenclature

| | | |
|---|---|---|
| WINNCARE F r a n c e | VAXT6/POMPE/AUTO AXTAIR AUTOMORPHO AXENSOR | Article : VAXT6/POMPE/AUTO |
| Ensemble - Nomenclature SAV | | Matière : |
| Dessinateur : JH / Cds : 11/0913 / MAJ : 28/11/22 | | Tolérances générales : |
| Référence : ECL_VAXT6/POMPE/AUTO | | Tous les repérages en caractères gras sont à associer à la fiche. |
| | | Page: 1/1 |
| | | Ech. N/A |
| | | A3 |

List of references: VAXT6/POMPE/AUTO

| Rep. | Before References | After ** References | Designation |
|------|----------------------|------------------------|--|
| 1 | PB2050521 | | Self-adhesive isophonic foam |
| 2 | PB2050163 | | Power cord & clips |
| 3 | WS/01/0073* | | Air distributor assembly |
| 3.1 | PB2050118* | | Motor 0.83RPM CW+ connections |
| 4 | WS/01/0074* | | Pump assembly |
| 4.1 | PB2050127* | | Stentbloc |
| 4.2 | PB2050135* | | Air pump |
| 4.3 | PB2050126* | | Pump support |
| 5 | WS/01/0075* | WS/01/0086** | Front shell assembly |
| 6 | WS/01/0076* | WS/01/0087** | Rear shell assembly |
| 6.1 | PB2050171 | | Fixing hook |
| 6.2 | PB2050140* | PB2050343** | Fixing bracket hook |
| 6.3 | PB2050136 | | air filter |
| 6.4 | PB2050139 | | Filter cover |
| 11 | | | references depend on the language of your country*** |
| 12 | PB2050146* | PB2050530** | Rear sticker |
| 13 | WS/01/0080* | WS/01/0080** | Female air/data connector + Axensor Bluetooth card |
| 14 | WS/01/0081* | | Electronic PCB+ support x 2 |
| 14.1 | PB2050138* | | PCB support |
| 15 | PB2050153* | | 230 volt female connector |
| 16 | PB2050154 | | Ceramic Fuse 5x20 |
| 17 | PB2050178* | | Bluetooth PCB support |
| 18 | PB2050553 | | QR CODE Sticker |
| // | PB2050337* | | Single-dose grease |
| // | VAXT/KITREV01* | | Overhaul kit (all components required for the standard AirCare overhaul) |

* The use of these references requires the completion of AirCare training.

** Compatible references if the serial number is **higher** than :

- 18458140 (VAXT/POMPE/AUTOP)

- 18457072 (VAXT/POMPE/ONEP)

*** PB2050567 = GB PB2050576 = IT PB2050585 = PT

PB2050570 = DE PB2050579 = NL PB2050588 = DK

PB2050573 = ES PB2050582 = PL PB2050591 = SK

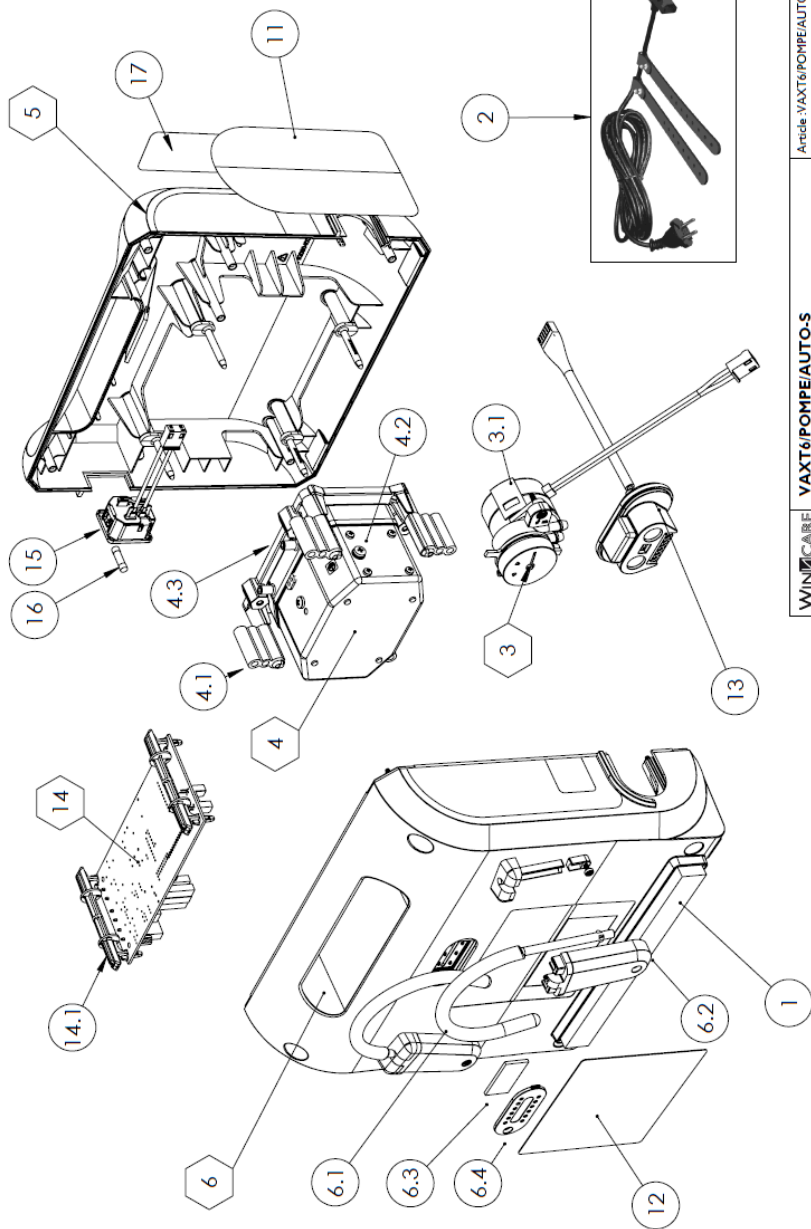

WINNOCARE
F r a n c e

VAXT6/POMPE/AUTO-S
AXTAIR AUTOMORPHO AXENSOR

Article : VAXT6/POMPE/AUTO-S

Matériau :

Tolérances générales :

Ce document est la propriété de la société WINNOCARE. Toute réimpression est interdite, sauf autorisation écrite.

Ensemble : Non standard SAV
Destinateur : JH / Crie : 12/10/21 - MAJ : 25/11/22

Référence : ECL_VAXT6/POMPE/AUTO

Page: 1/1

Ech. N/A

A3

Merci de se référer à la NU_PA0010142 pour la nomenclature

| Rep. | References | Designation |
|------|---|--|
| 1 | PB2050521 | Self-adhesive isophonic foam |
| 2 | PB2050163 | Power cord & clips |
| 3 | WS/01/0073* | Air distributor assembly |
| 3.1 | PB2050118* | Motor 0.83RPM CW+ connections |
| 4 | WS/01/0074* | Pump assembly |
| 4.1 | PB2050127* | Silentbloc |
| 4.2 | PB2050135* | Air pump |
| 4.3 | PB2050126* | Pump support |
| 5 | WS/01/0092* | Front shell assembly |
| 6 | WS/01/0087* | Rear shell assembly |
| 6.1 | PB2050171 | Fixing hook |
| 6.2 | PB2050343 | Fixing bracket hook |
| 6.3 | PB2050136 | air filter |
| 6.4 | PB2050139 | Filter cover |
| 11 | references depend on the language of your country*** | Axtair side sticker |
| 12 | PB2050530 | Rear sticker |
| 13 | WS/01/0093* | Female air/data connector + wiring |
| 14 | WS/01/0081* | Electronic PCB+ support x 2 |
| 14.1 | PB2050138* | PCB support |
| 15 | PB2050153* | 230 volt female connector |
| 16 | PB2050154 | Ceramic Fuse 5x20 |
| 17 | PB2050553 | QR CODE Sticker |
| // | PB2050337* | Single-dose grease |
| // | VAXT/KITREV01* | Overhaul kit (all components required for the standard AirCare overhaul) |

* The use of these references requires the completion of AirCare training.

*** PB2050567= GB PB2050576 = IT PB2050585 = PT

PB2050570 = DE PB2050579 = NL PB2050588 = DK

PB2050573 = ES PB2050582 = PL PB2050591 = SK

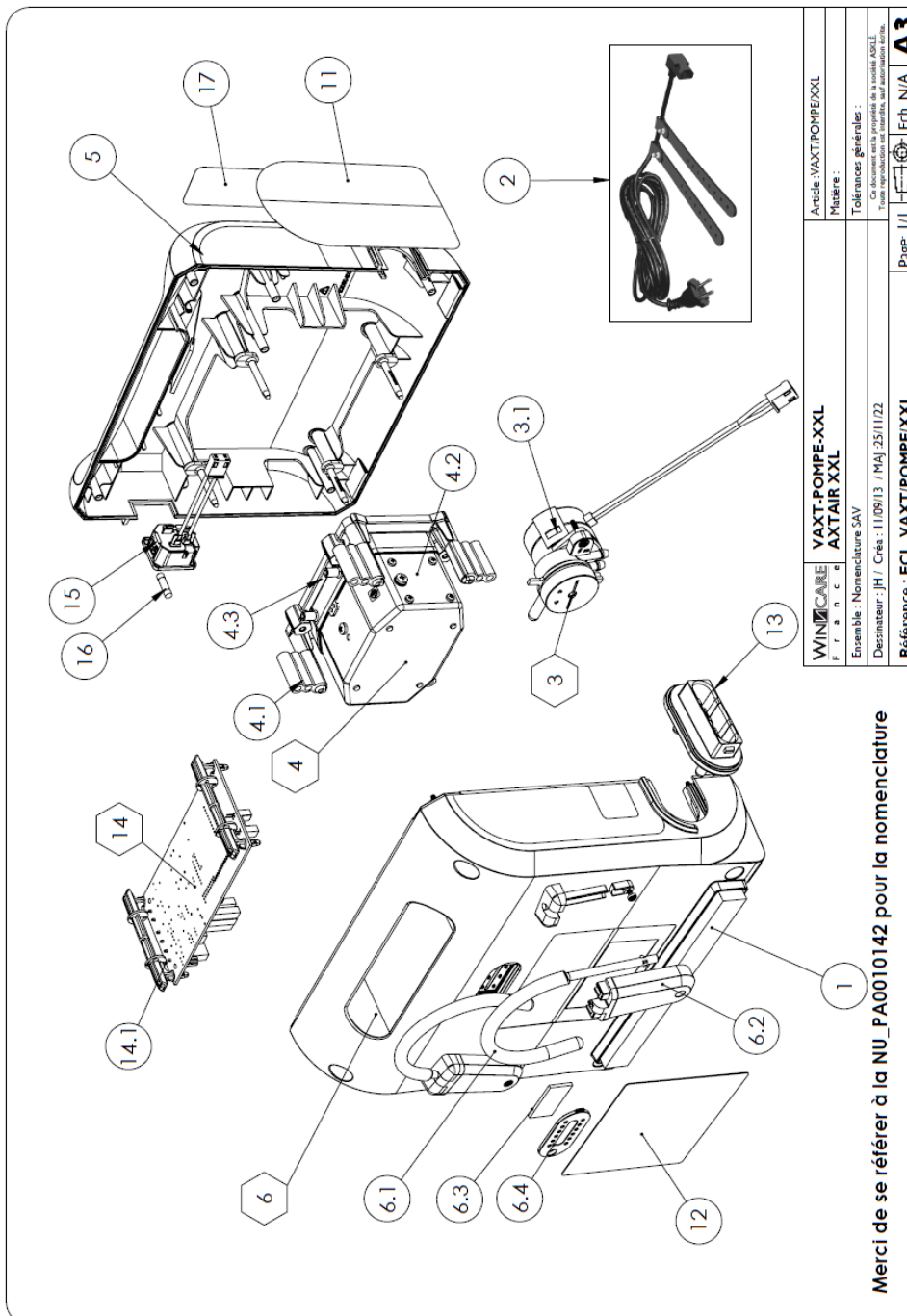

| | | |
|---|--|-------------------------|
| WINNCARE F r a n c e | VAXT-POMPE-XXL AXTAIR XXL | Article: VAXT/POMPE/XXL |
| Ensemble: Non-enclosure SAV | | Matière : |
| Descripteur: JH / Crea : I10913 / MAJ : 25/11/22 | | Tolérances générales : |
| Référence : ECL_VAXT/POMPE/XXL Cet document est la propriété de la société ASILE Toute réimpression est interdite, sauf autorisation écrite. | | Ech: N/A |
| | | Page: 1/1 |

Merci de se référer à la NU_PA0010142 pour la nomenclature

List of references: VAXT/POMPE/ XXL

| Rep. | References | Designation |
|------|--|--|
| 1 | PB2050521 | Self-adhesive isophonic foam |
| 2 | PB2050163 | Power cord & clips |
| 3 | WS/01/0073* | Air distributor assembly |
| 3.1 | PB2050118* | Motor 0.83RPM CW+ connections |
| 4 | WS/01/0074* | Pump assembly |
| 4.1 | PB2050127* | Silentbloc |
| 4.2 | PB2050135* | Air pump |
| 4.3 | PB2050126* | Pump support |
| 5 | WS/01/0088* | Front shell assembly |
| 6 | WS/01/0087* | Rear shell assembly |
| 6.1 | PB2050171 | Fixing hook |
| 6.2 | PB2050343 | Fixing bracket hook |
| 6.3 | PB2050136 | Air filter |
| 6.4 | PB2050139 | Filter cover |
| 11 | references depend on the language of your country*** | Side sticker Axtair |
| 12 | PB2050530 | Rear sticker |
| 13 | PB2050210* | Female Connector |
| 14 | WS/01/0081* | Electronic PCB+ support x 2 |
| 14.1 | PB2050138* | PCB support |
| 15 | PB2050153* | 230 volt female connector |
| 16 | PB2050154* | Ceramic Fuse 5x20 |
| 17 | PB2050553 | QR CODE Sticker |
| // | PB2050337* | Single-dose grease |
| // | VAXT/KITREV01* | Overhaul kit (all components required for the standard AirCare overhaul) |

* the use of these references requires the AirCare training

*** PB2050568 = GB PB2050577 = IT PB2050586 = PT

PB2050571 = DE PB2050580 = NL PB2050589 = DK

PB2050574 = ES PB2050583 = PL PB2050592 = SK

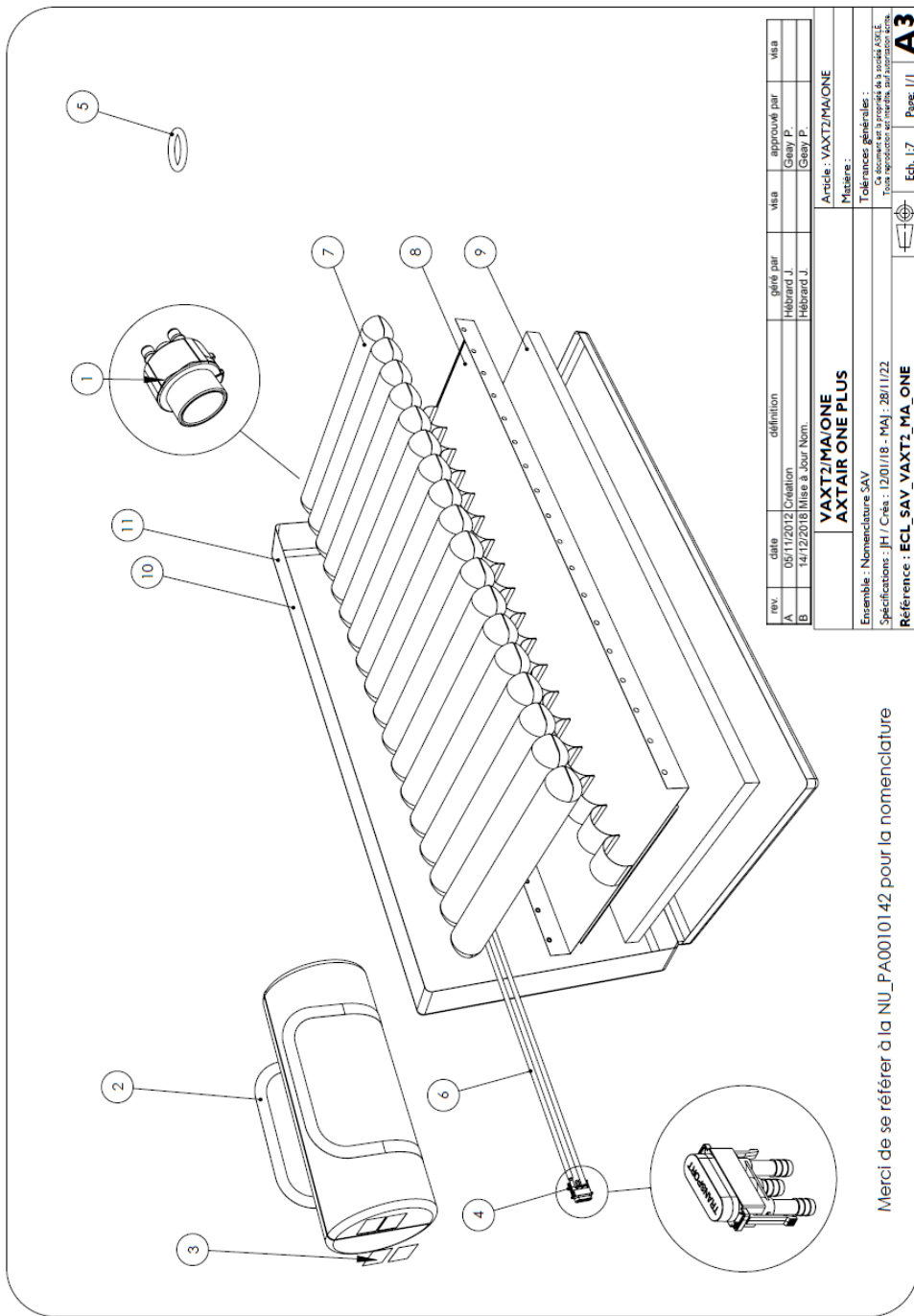

| rev. | date | description | dessiné par | visé | approuvé par | visa |
|------|------------|-------------------|-------------|------|--------------|------|
| A | 05/12/2012 | Création | Hébrard J | | Geay P. | |
| B | 14/12/2018 | Mise à jour Norm. | Hébrard J | | Geay P. | |

Article : VAXT2/MA/ONE
 Matière :

Ensemble : Nomenclature SAV

Spécifications : FH / Cires : 1200/18 - MAJ : 28/11/22

Préférence : ECL_SAV_VAXT2_MA_ONE

Merci de se référer à la NU_PA0010142 pour la nomenclature

Tolérances générales :
 Tous repérages en mètres, sauf précision légal.

Ech. 1/7

Page 1/1



A3

List of references: VAXT/MA/ONE

| Rep. | References | Designation |
|------|----------------|---|
| 1 | WS/02/0052 | 2 position rotary CPR valve |
| 2 | VAXT/SB | Transport bag |
| 3 | PB2050593 | Dirty/clean label |
| 4 | PB2050213 | Complete male pneumatic connector |
| 5 | PB0050026 | O-ring for male connector |
| 6 | PB2040069 | Grey pipe |
| 7 | PB2040116 | Automorpha & One 2 PU cell - 87 cm |
| 8 | PB2040124 | Axtair holding sheet - 87 cm : AT12/V4/ONE2/ONE PLUS |
| 9 | VAXT/MS | Single mattress AXTAIR |
| 10 | VHCIC/AXT2/ONE | Complete Cover CIC |
| 11 | VHIP/AXT2/ONE | Complete Cover PU |

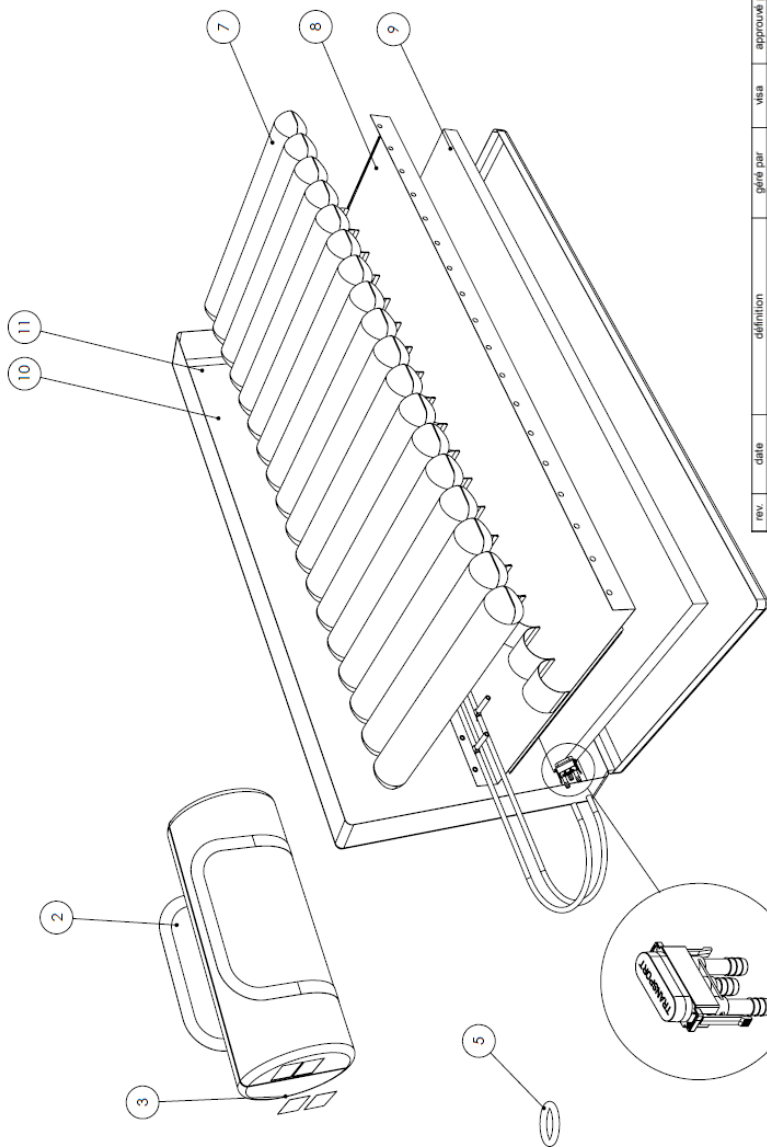

| rev. | date | definition | visé par | visa | approuvé par |
|------|------------|-----------------|------------|------|--------------|
| A | 05/11/2012 | Création | Hébrard J. | | Geay P. |
| B | 14/12/2018 | Mise à jour Nom | Hébrard J. | | Geay P. |

| | |
|---|--|
| Article : VAXT_MONEP90_PUL | |
| Matière : | |
| Ensemble : Nomenclature SAV | |
| Spécifications : JH / Créa : 2811/22 | |
| Tolérances générales : | |
| Tous les composants sont en acier inoxydable. | |
| Tous les composants sont en acier inoxydable. | |

| | |
|--|-----------|
| Référence : ECL_SAV_VAXT_MONEP90_PUL Ech. 1:7 Page 1/1 | A3 |
|--|-----------|

Merci de se référer à la NU_PA0010142 pour la nomenclature

List of references: VAXT/MONEP90/PUL OR CIC

| Rep. | References | Designation |
|------|----------------|---|
| 1 | VAXT/SB | Transport bag |
| 2 | PB2050593 | Dirty/clean label |
| 3 | PB2050539 | Complete male pneumatic connector |
| 4 | PB0050026 | O-ring for male connector |
| 5 | PB2040069 | Grey pipe |
| 6 | PB2040116 | Automorpha & One 2 PU cell - 87 cm |
| 7 | PB2040124 | Axtair holding sheet - 87 cm : ATI2/V4/ONE2/ONE PLUS |
| 8 | PB2050536 | T Connector |
| 9 | PB2050537 | L Connector |
| 10 | VHCIC/AXT/ONEP | Complete Cover CIC |
| 11 | VHIP/AXT/ONEP | Complete Cover PU |
| 12 | VAXT/MS | Single mattress AXTAIR |

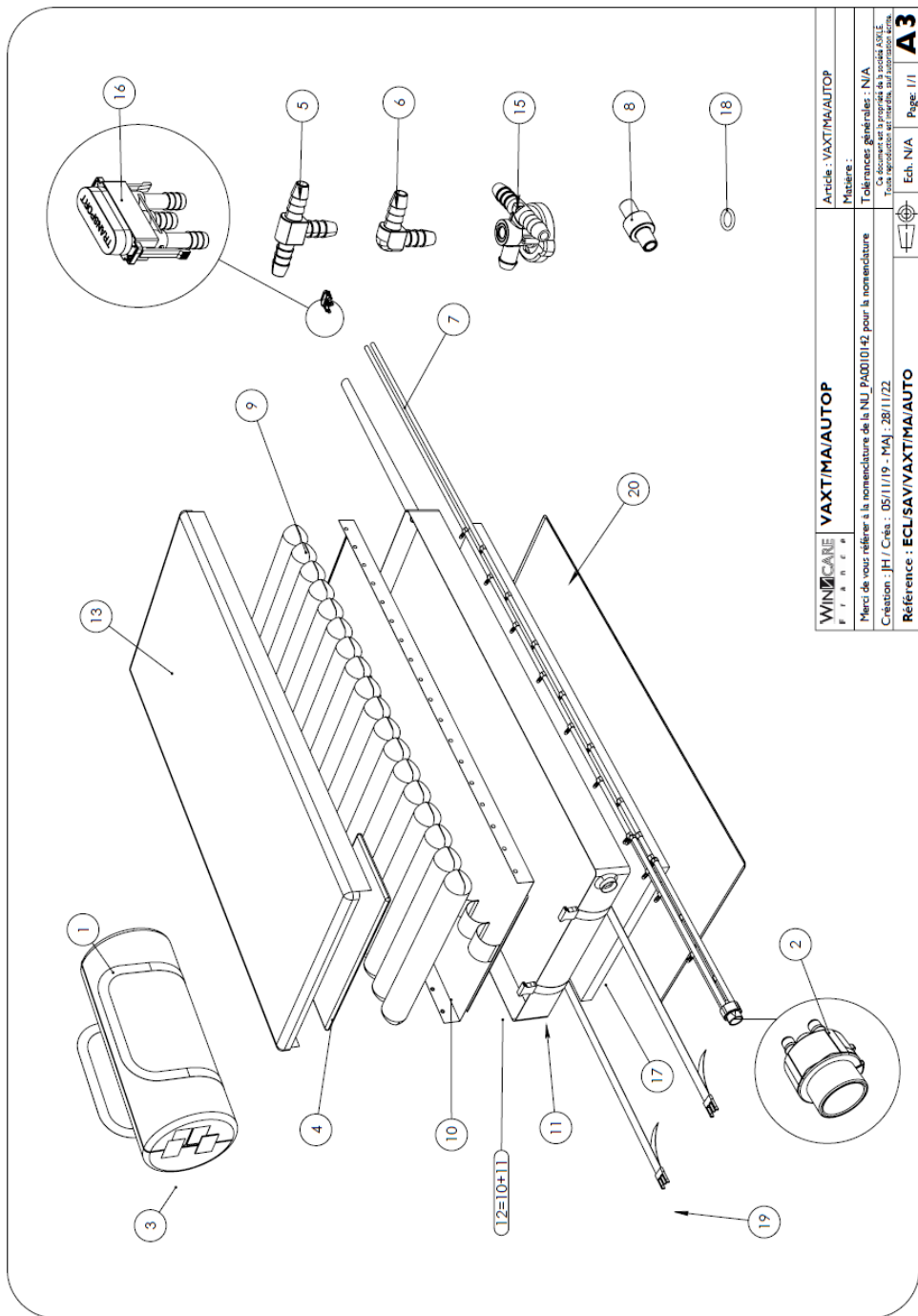

| | | |
|---|----------------------|---|
| WINNOCARE F I R M E | VAXT/MA/AUTOP | Article : VAXT/MA/AUTOP |
| Merci de vous référer à la nomenclature de la NU P40010142 pour la nomenclature | | Matériau : N/A |
| Creation : JH / Créa : DS / 11 / 19 - MAJ : 28 / 11 / 22 | | Tolérances générales : N/A |
| Référence : ECLSA/VAXT/MA/AUTO | | Tous droits réservés à WINNOCARE FRANCE |
| | | Tous droits réservés à WINNOCARE FRANCE |
| | | Ech. N/A Page 1/1 |

| Rep. | References | Designation |
|------|-----------------|---|
| 1 | VAXT/SB | Transport bag |
| 2 | WS/02/0052 | 2 position rotary CPR valve |
| 3 | PB2050593 | Dirty/clean label |
| 4 | PB2050497 | Foam head cushion |
| 5 | PB2050536 | T Connector |
| 6 | PB2050537 | L Connector |
| 7 | PB2040069 | Grey pipe |
| 8 | PB2050285 | Non-return valve + silencer |
| 9 | PB2040116 | Automorpha & One 2 PU cell - 87 cm |
| 10 | PB2040124 | Axtair holding sheet - 87 cm : AT12/V4/ONE2/ONE PLUS |
| 11 | PB2050167 | MA AUTO PVC base - 87 cm |
| 12 | PB2050219 | MA AUTO PVC base - 87 cm+ Holding sheet |
| 13 | VHC/C/AXT90-H** | Top cover Axtair CIC |
| 14 | VHPH/AXT90-H** | Top cover Axtair PUHD |
| 15 | PB2050531 | Heel discharge valve |
| 16 | PB2050213 | Complete male pneumatic connector complete |
| 17 | VAXT/MS | Single mattress AXTAIR |
| 18 | PB0050026 | O-ring for male connector |
| 19 | PB2050093 | Built-in buckle 38 mm |
| 20 | VHAG/AXT-B | Axtair Antislip bottom cover |

*the use of these references requires the AirCare training

** CIC cover allows the use of the original pillow. Not the case for the PUHD version

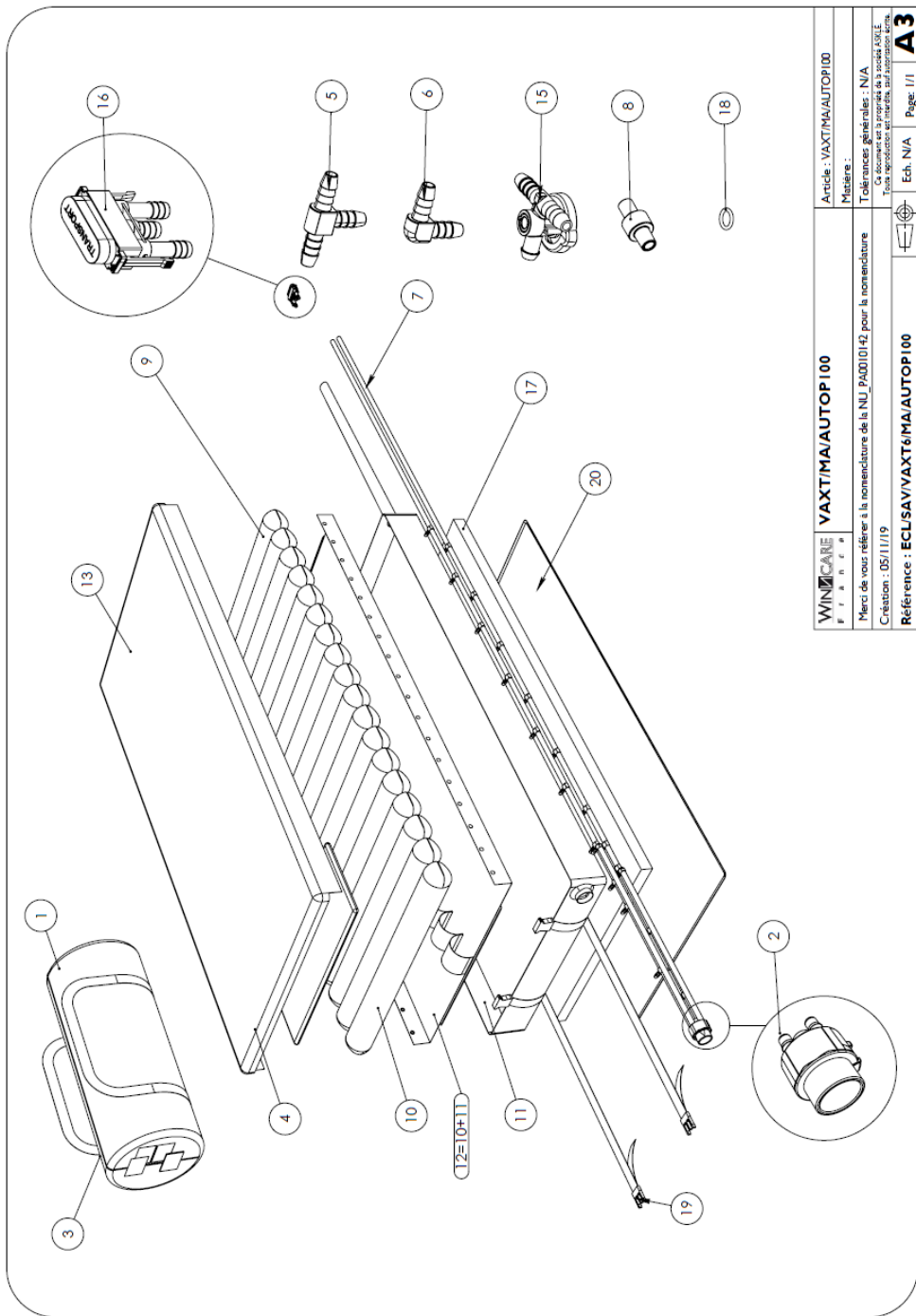

| | | |
|---|-------------------------|----------------------------|
| WINNOCARE | VAXT/MA/AUTOP100 | Article : VAXT/MA/AUTOP100 |
| Part number | | Matière : |
| Merci de vous référer à la nomenclature de la NU_PA0010142 pour la nomenclature | | |
| Tolérances générales : N/A | | |
| Création : 05/11/19 | | |
| Ce document est la propriété de la société AXI, L. Toute réimpression est interdite, sauf autorisation écrite. | | |
| Référence : ECLUSAV/VAXT6/MA/AUTOP100 | | Ech. N/A Page: 1/1 |

List of references: VAXT/MA/AUTOP100

| Rep. | References | Designation |
|------|------------------|--|
| 1 | VAXT/SB-XL | Transport Bag Axtair XL |
| 2 | WS/02/0052 | 2 position rotary CPR valve |
| 3 | PB2050593 | Dirty/clean label |
| 4 | PB2050497 | Foam head cushion |
| 5 | PB2050536 | T connector |
| 6 | PB2050537 | L connector |
| 7 | PB2040069 | Grey pipe |
| 8 | PB2050285 | Non-return valve + silencer |
| 9 | PB2040131 | PU cell 1 end cap L97 H12 |
| 10 | PB2050287 | Axtair holding sheet Auto 100 |
| 11 | PB2050286 | MA AUTO PVC base Auto 100 |
| 12 | PB2050288 | MA AUTO PVC base Auto 100 + holding sheet |
| 13 | VHCIC/AXT100-H** | Top cover Axtair 100 CIC |
| 14 | VHPH/AXT100-H** | Top cover Axtair 100 PUHD |
| 15 | PB2050531 | Heel discharge valve |
| 16 | PB2050213 | Complete male pneumatic connector complete |
| 17 | VAXT/MS/100 | Single mattress AXTAIR AUTO 100 |
| 18 | PB0050026 | O-ring for male connector |
| 19 | PB2050093 | Built-in buckle 38 mm |
| 20 | VHAG/AXT/100-B | Axtair Antislip bottom cover AUTO 100 |

*the use of these references requires the AirCare training

** CIC cover allows the use of the original pillow. Not the case for the PUHD version

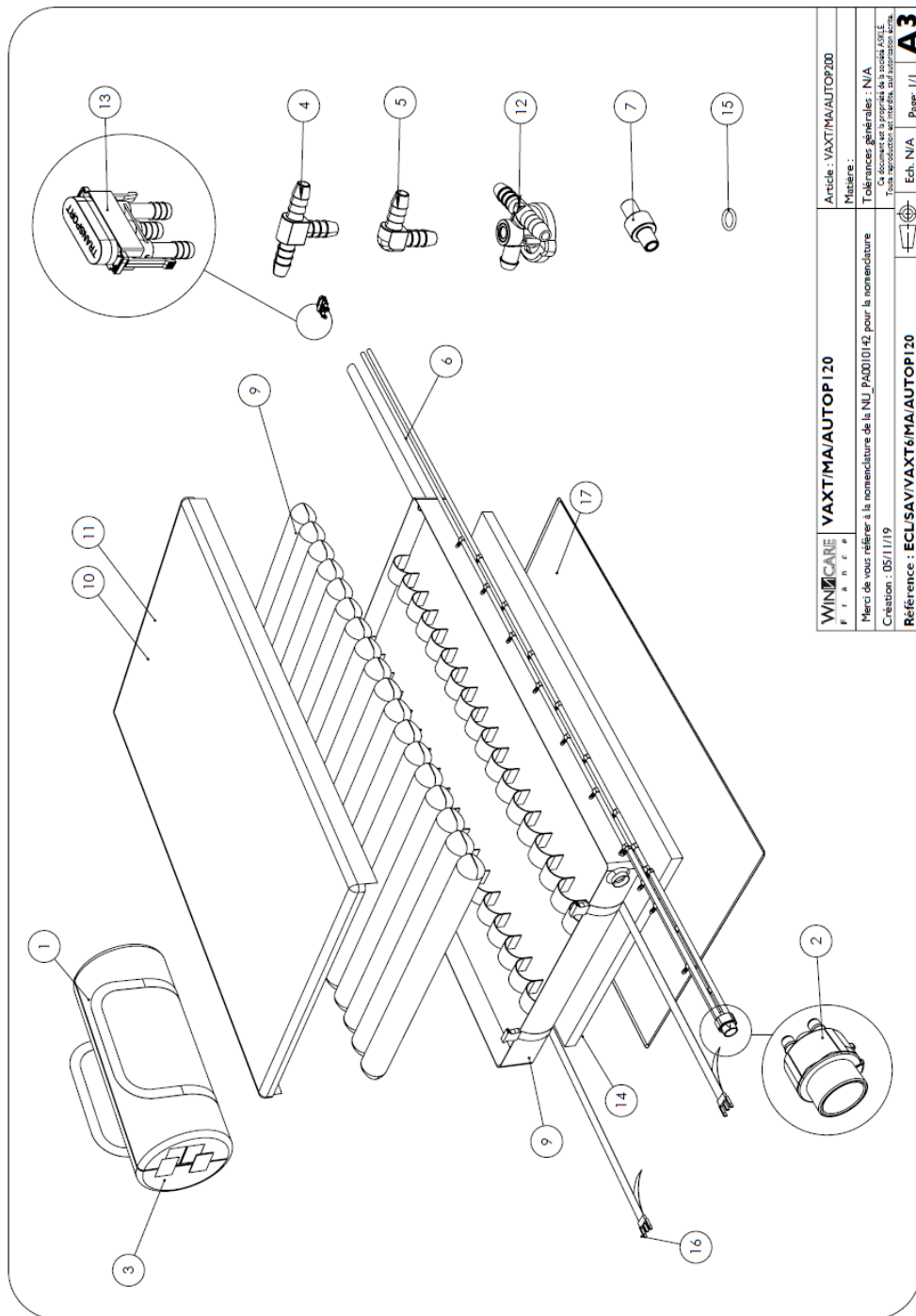

| | | |
|---|------------------|---|
| WINNOCARE | VAXT/MA/AUTOP120 | Article : VAXT/MA/AUTOP120 |
| F r a n c e | | Pièce n° : |
| Merci de vous référer à la nomenclature de la N.LJ_PA0010142 pour la nomenclature | | Tolérances générales : N/A |
| Création : 05/11/19 | | Ce document est la propriété de la société WINNOCARE. Toute réimpression ou utilisation non autorisée sans la permission écrite de la société est formellement interdite. |
| Référence : ECL/SAV/VAXT/MA/AUTOP120 | | Ech. N/A Page. 1/1 |

List of references: VAXT/MA/AUTOP120

| Rep. | Références | Désignation |
|------|-----------------|--|
| 1 | VAXT/SB-XL | Transport Bag Axtair XL |
| 2 | WS/02/0052 | 2 position rotary CPR valve |
| 3 | PB2050593 | Dirty/clean label |
| 4 | PB2050536 | T connector |
| 5 | PB2050537 | L connector |
| 6 | PB2040069 | Grey pipe |
| 7 | PB2050285 | Non-return valve + silencer |
| 8 | PB2040126 | PU cell 1 end cap L117 H12 |
| 9 | PB2050066 | MA AUTO PVC base Auto 120 |
| 10 | VHCIC/AXT1120-H | Top cover Axtair 120 CIC |
| 11 | VHPH/AXT1120-H | Top cover Axtair 120 PUHD |
| 12 | PB2050531 | Heel discharge valve |
| 13 | PB2050213 | Complete male pneumatic connector complete |
| 14 | VAXT/MS/XL | Single mattress AXTAIR AUTO 120 |
| 15 | PB0050026 | O-ring for male connector |
| 16 | PB2050093 | Built-in buckle 38 mm |
| 17 | VHAG/AXT/XL-B | Axtair Antislip bottom cover AUTO 120 |

*the use of these references requires the AirCare training

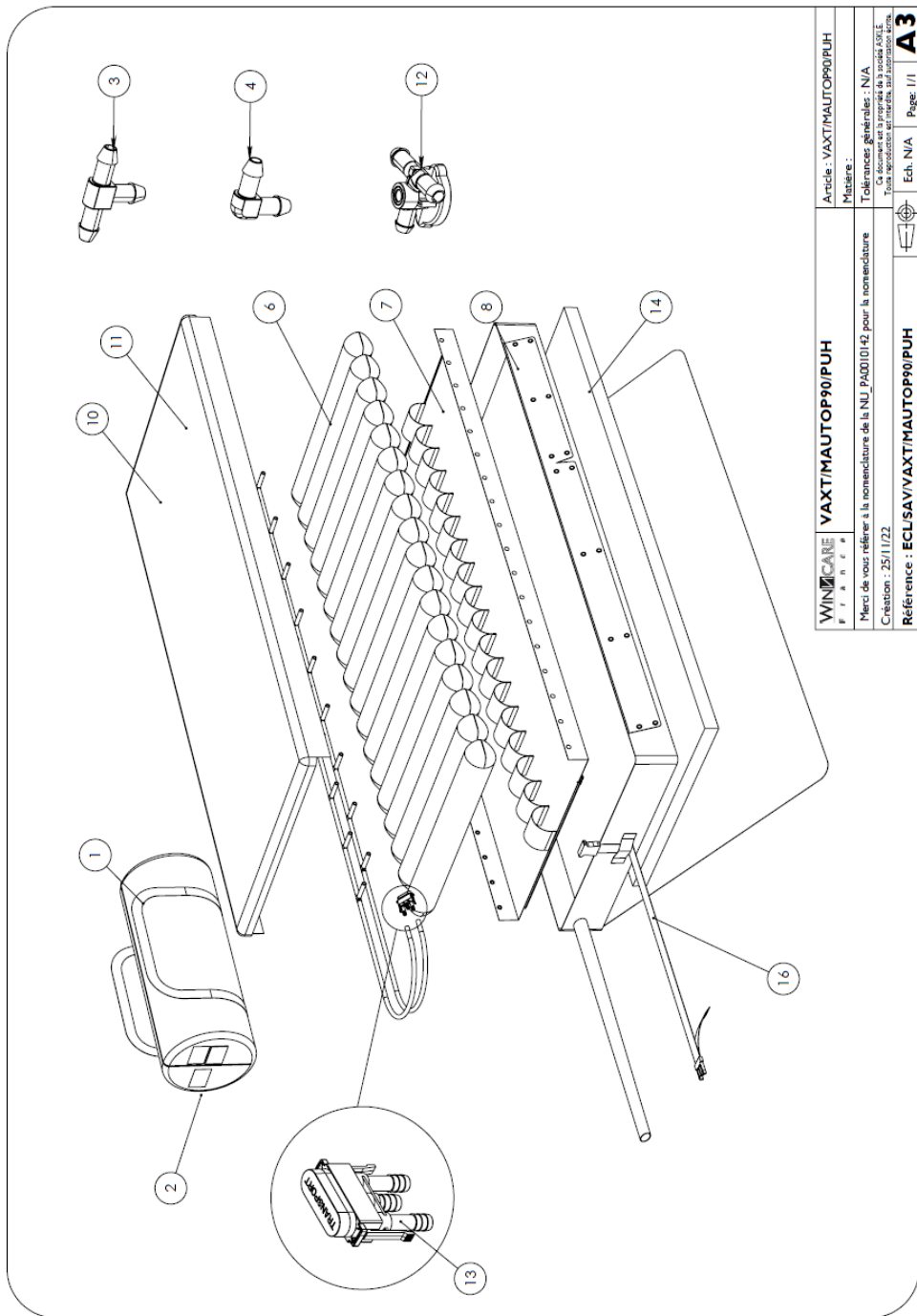

| | | |
|--|--------------------------|---|
| WINNCARE F. I. S. S. I. S. | VAXT/MAUTOP90/PUH | Article : VAXT/MAUTOP90/PUH |
| Merci de vous référer à la nomenclature de la NUJ_P40010142 pour la nomenclature | | Matière : |
| Création : 25/11/22 | | Tolérances générales : N/A |
| Référence : ECLUSAVVAXT/MAUTOP90/PUH | | Tolérances particulières : voir le dessin |
| | | Ech. : N/A |
| | | Page : 1/1 |

A3

List of references: VAXT/MAUTOP90/PUH ou /CIC

| Rep. | References | Designation |
|------|---------------|---|
| 1 | VAXT/SB | Transport bag |
| 2 | PB2050593 | Dirty/clean label |
| 3 | PB2050536 | T Connector |
| 4 | PB2050537 | L Connector |
| 5 | PB2040069 | Grey pipe |
| 6 | PB2040116 | Automorpho & One 2 PU cell - 87 cm |
| 7 | PB2040124 | Axtair holding sheet - 87 cm : AT12/V4/ONE2/ONE PLUS |
| 8 | PB2050534 | MA AUTO PVC base - 87 cm |
| 9 | PB2050535 | MA AUTO PVC base - 87 cm+ Holding sheet |
| 10 | VHCIC/AXT90-H | Top cover Axtair CIC |
| 11 | VPH/AXT90-H | Top cover Axtair PUHD |
| 12 | PB2050531 | Heel discharge valve |
| 13 | PB2050539 | Complete male pneumatic connector complete |
| 14 | VAXT/MS | Single mattress AXAIR |
| 15 | PB0050026 | O-ring for male connector |
| 16 | VAXT/SANG | Axtair Strap Base |

*the use of these references requires the AirCare training

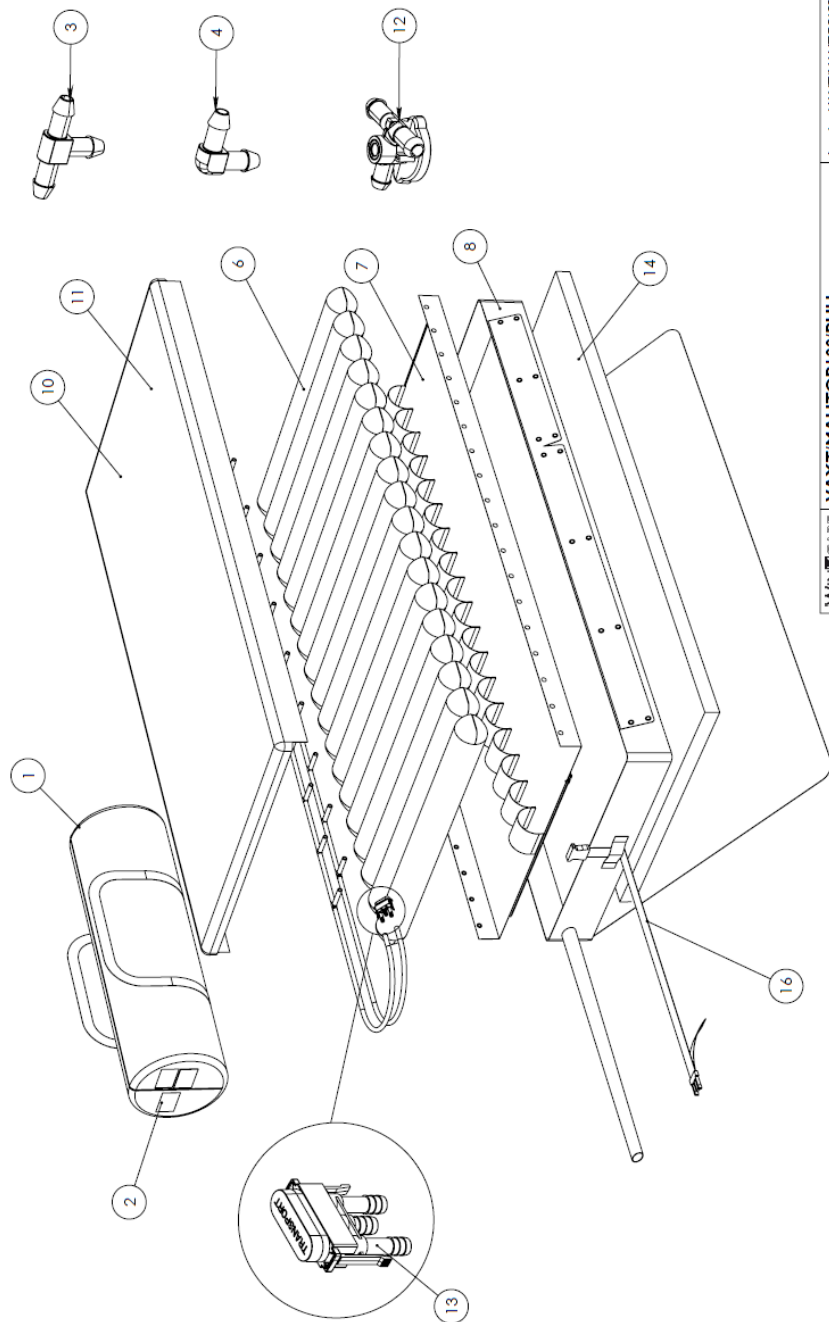

| | | |
|--|--------------------|---|
| WINNCARE F I R M E | VAXT/MAUTOP100/PUH | Article : VAXT/MAUTOP100/PUH |
| Merci de vous référer à la nomenclature de la NUJ_P40010142 pour la nomenclature | | Matière : |
| Création : 25/11/2022 | | Téléfonces géométriques : N/A |
| Référence : ECL-SAV/VAXT/MAUTOP100/PUH | | Ce document est propriété de la société WINNCARE Tous droits réservés et réservés, sauf autorisation écrite. |
| | | Ech. N/A Page. 1/1 |



List of references: VAXT/MAUTOP100/PUH or /CIC

| Rep. | References | Designation |
|------|----------------|--|
| 1 | VAXT/SB-XL | Transport Bag Axtair XL |
| 3 | PB2050593 | Dirty/clean label |
| 5 | PB2050536 | T connector |
| 6 | PB2050537 | L connector |
| 7 | PB2040069 | Grey pipe |
| 9 | PB2040131 | PU cell 1 end cap L97 H12 |
| 10 | PB2050287 | Axtair holding sheet Auto 100 |
| 11 | PB2050557 | MA AUTO PVC base Auto 100 |
| 11 | PB2050558 | MA AUTO PVC base Auto 100 + Holding sheet |
| 13 | VHCIC/AXT100-H | Top cover Axtair 100 CIC |
| 14 | VHPH/AXT100-H | Top cover Axtair 100 PUHD |
| 15 | PB2050531 | Heel discharge valve |
| 16 | PB2050539 | Complete male pneumatic connector complete |
| 14 | VAXT/MS/100 | Single mattress AXTAIR Auto Plus 100 |
| 18 | PB0050026 | O-ring for male connector |
| 16 | VAXT/SANG | Axtair Strap Base |

*the use of these references requires the AirCare training

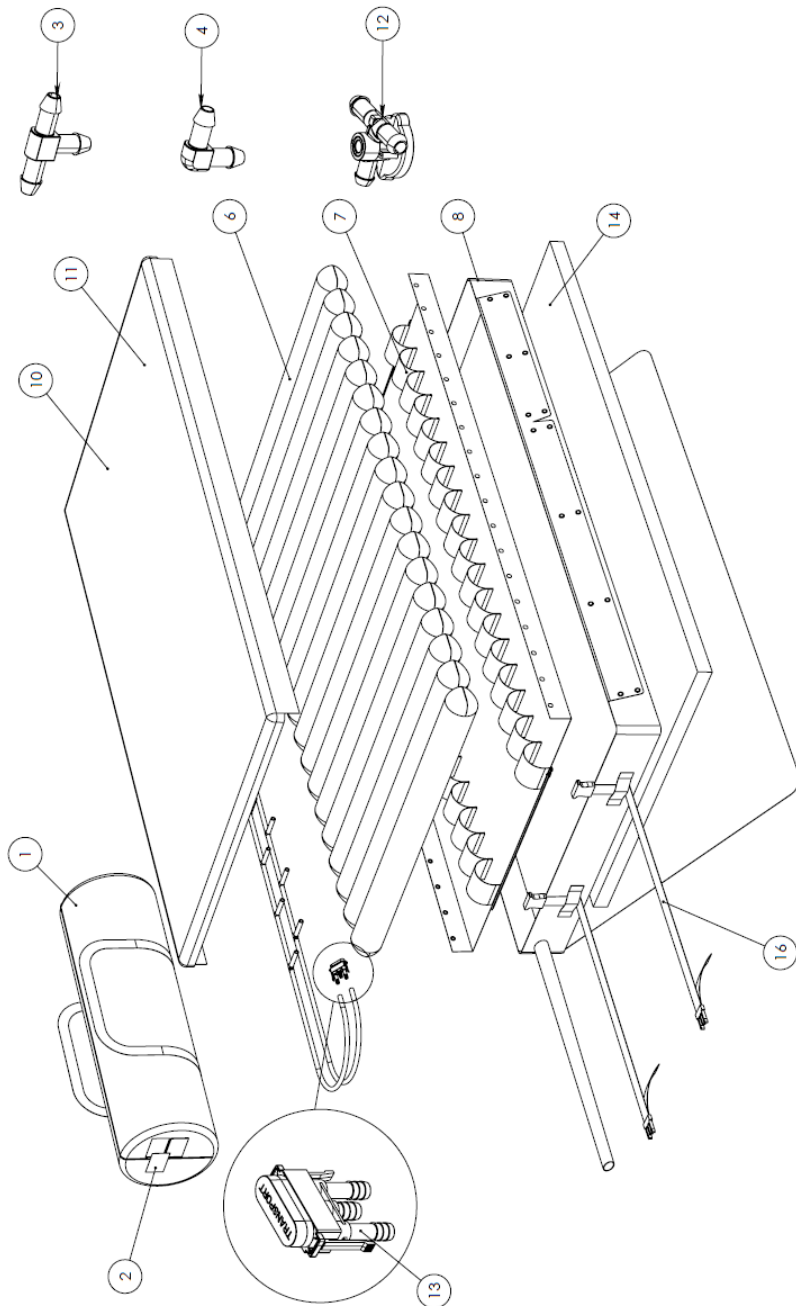

| | | |
|--|---------------------------|---|
| WINNOCARE F r a n c e | VAXT/MAUTOP120/PUH | Article : VAXT/MAUTOP120/PUH |
| Merci de vous référer à la nomenclature de la NUJ P40010142 pour la nomenclature | | Matériau : N/A |
| Création : 25/11/22 | | Tolérances générales : N/A |
| Référence : ECL/SAV/VAXT/MAUTOP120/PUH | | Tous droits réservés. Toute réimpression sans autorisation écrite est formellement interdite. |
| | | Ech. N/A Page 1/1 |

A3

List of references: VAXT/MAUTOP120/PUH or /CIC

| Rep. | Références | Désignation |
|------|----------------|--|
| 1 | VAXT/SB-XL | Transport Bag Axtair XL |
| 3 | PB2050593 | Dirty/clean label |
| 4 | PB2050536 | T connector |
| 5 | PB2050537 | L connector |
| 6 | PB2040069 | Grey pipe |
| 8 | PB2040126 | PU cell 1 end cap L117 H12 |
| 7 | PB2050554 | Axtair holding sheet Auto 120 |
| 8 | PB2050555 | MA AUTO PVC base Auto 120 |
| 9 | PB2050556 | MA AUTO PVC base Auto 120 + Holding sheet |
| 10 | VHCIC/AXT120-H | Top cover Axtair 120 CIC |
| 11 | VHPH/AXT120-H | Top cover Axtair 120 PUHD |
| 12 | PB2050531 | Heel discharge valve |
| 13 | PB2050539 | Complete male pneumatic connector complete |
| 14 | VAXT/MS/XL | Single mattress AXTAIR AUTO 120 |
| 15 | PB0050026 | O-ring for male connector |
| 16 | VAXT/SANG | Axtair Strap Base |

*the use of these references requires the AirCare training

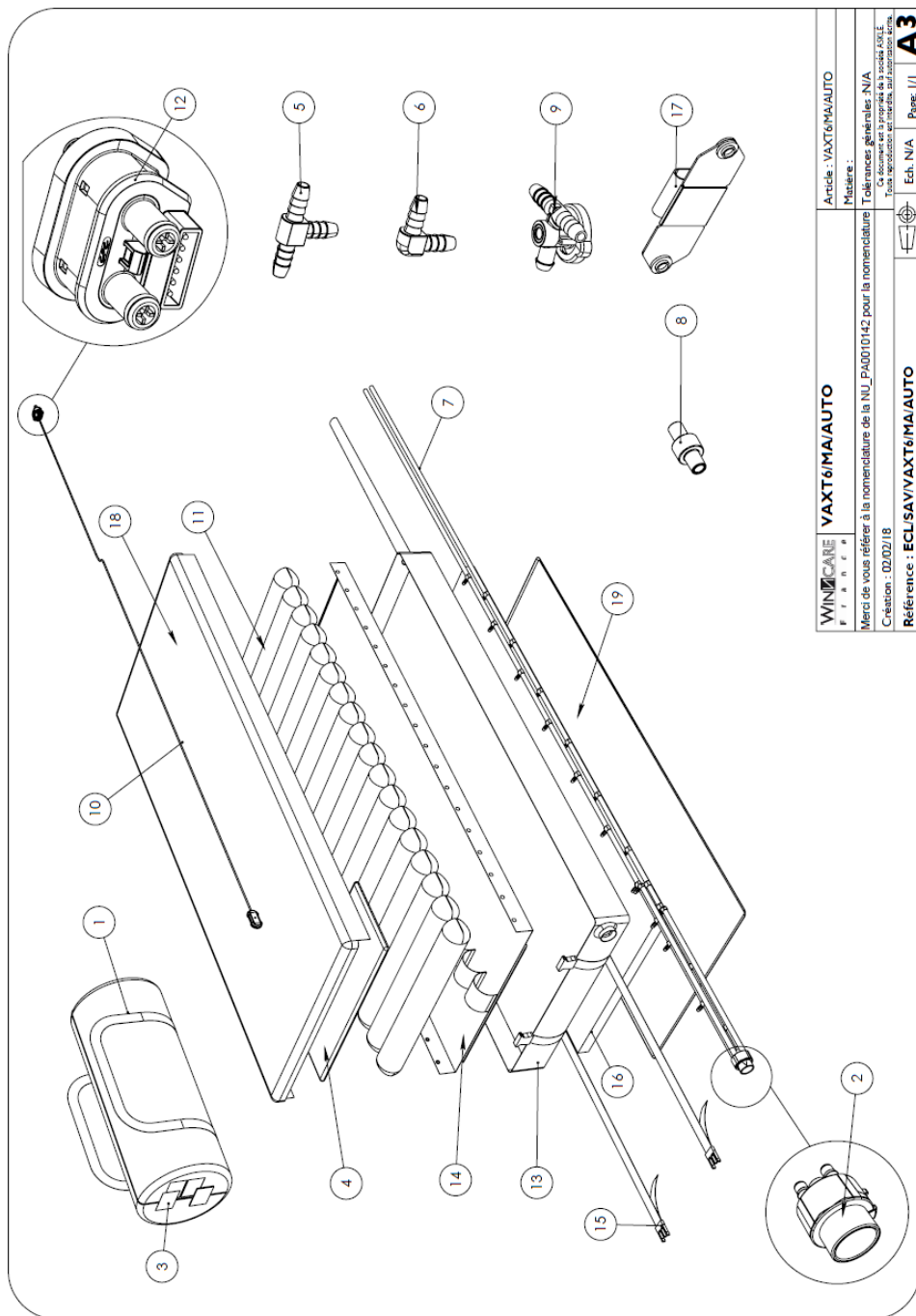

| | | |
|---|----------------------|---|
| WINCARE F R A N C E | VAXT6/MA/AUTO | Article : VAXT6/MA/AUTO |
| Merci de vous référer à la nomenclature de la NU_PA0010142 pour la nomenclature | | Matière : |
| Tous les composants sont en acier inoxydable A316 | | Tous les composants sont en acier inoxydable A316 |
| Création : 02/02/18 | | Ech. N/A Page 1/1 |
| Référence : ECLSAV/VAXT6/MA/AUTO | | A3 |

List of references: VAXT6/MA/AUTO

| Rep. | Reference | Designation |
|------|---------------|--|
| 1 | VAXT/SB | Transport bag |
| 2 | WS/02/0052 | 2 position rotary CPR valve |
| 3 | PB2050593 | Dirty/clean label |
| 4 | PB2050497 | Foam head cushion |
| 5 | PB2050536 | T connector |
| 6 | PB2050537 | L connector |
| 7 | PB2040069 | Grey pipe |
| 8 | PB2050285 | Non-return valve + silencer |
| 9 | PB2050531 | Heel discharge valve |
| 10 | WS/02/0054 | Male connector + Axensor sensor |
| 11 | PB2040116 | Automorpho & One 2 PU cell - 87 cm |
| 12 | PB2050162* | Hybrid male coupler |
| 13 | PB2050167 | Axensor AT12 Base |
| 14 | PB2050124 | Axtair holding sheet - 87 cm AT12/V4/ONE2 |
| 15 | PB2050093 | Built-in buckle 38 mm |
| 16 | VAXT/MS | Single mattress AUTO |
| 17 | PB2050333 | Axensor box support |
| 18 | VHCIC/AXT90-H | Top cover Axtair CIC |
| 19 | VHAXT/BAS | Axtair Antislip bottom cover |

*the use of these references requires the AirCare training

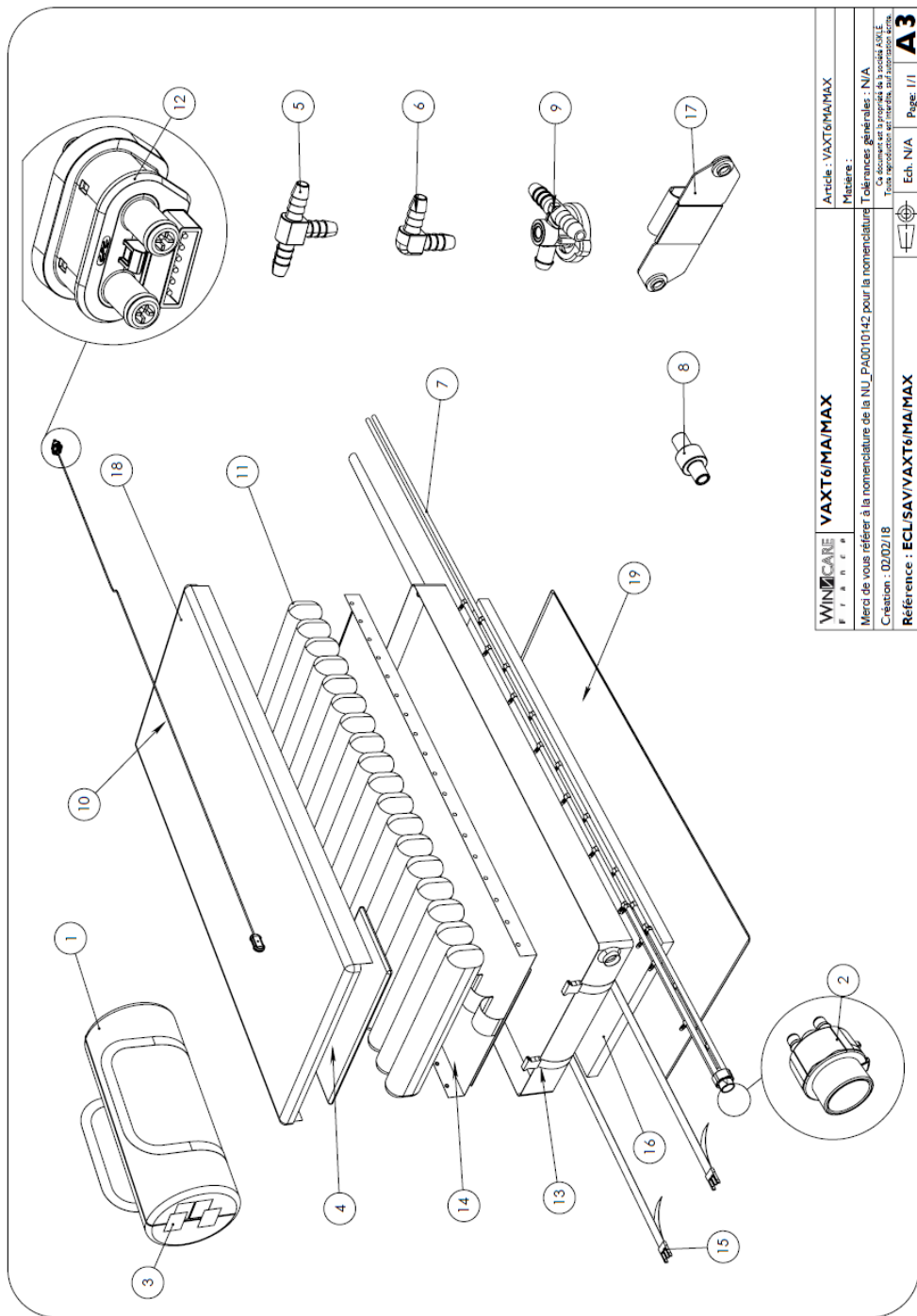

| | | |
|--|---------------------|------------------------|
| WINNCARE F R A N C E | VAXT6/MA/MAX | Article : VAXT6/MA/MAX |
| Merci de vous référer à la nomenclature de la NUL_PA0010142 pour la nomenclature | | Matière : |
| Tolérances générales : N/A | | |
| Création : 02/02/18 | | |
| Référence : ECL/SAV/VAXT6/MA/MAX | | Ech. N/A Page. 1/1 |

List of references: VAXT6/MA/MAX

| Rep. | Reference | Designation |
|------|---------------|-----------------------------------|
| 1 | VAXT/SB | Transport Bag |
| 2 | WS/02/0052 | 2 position rotary CPR valve |
| 3 | PB2050593 | Dirty/clean label |
| 4 | PB2050497 | Foam head cushion |
| 5 | PB2050536 | T connector |
| 6 | PB2050537 | L connector |
| 7 | PB2040069 | Grey pipe |
| 8 | PB2050285 | Non-return valve + silencer |
| 9 | PB2050531 | Heel discharge valve |
| 10 | WS/02/0054 | Male connector + Axensor sensor |
| 11 | PB2040128 | Axensor cell AT15 |
| 12 | PB2050162* | Hybrid male coupler |
| 13 | PB2050194 | Axensor base AT15 |
| 14 | PB2050193 | Axtair holding sheet Axensor AT15 |
| 15 | PB2050093 | Built-in buckle 38 mm |
| 16 | VAXT/MS | Single mattress AXTAIR |
| 17 | PB2050333 | Axensor box support |
| 18 | VHCIC/AXT90-H | Top cover Axtair CIC |
| 19 | VHAXT/BAS | Axtair Antislip bottom cover |

*the use of these references requires the AirCare training

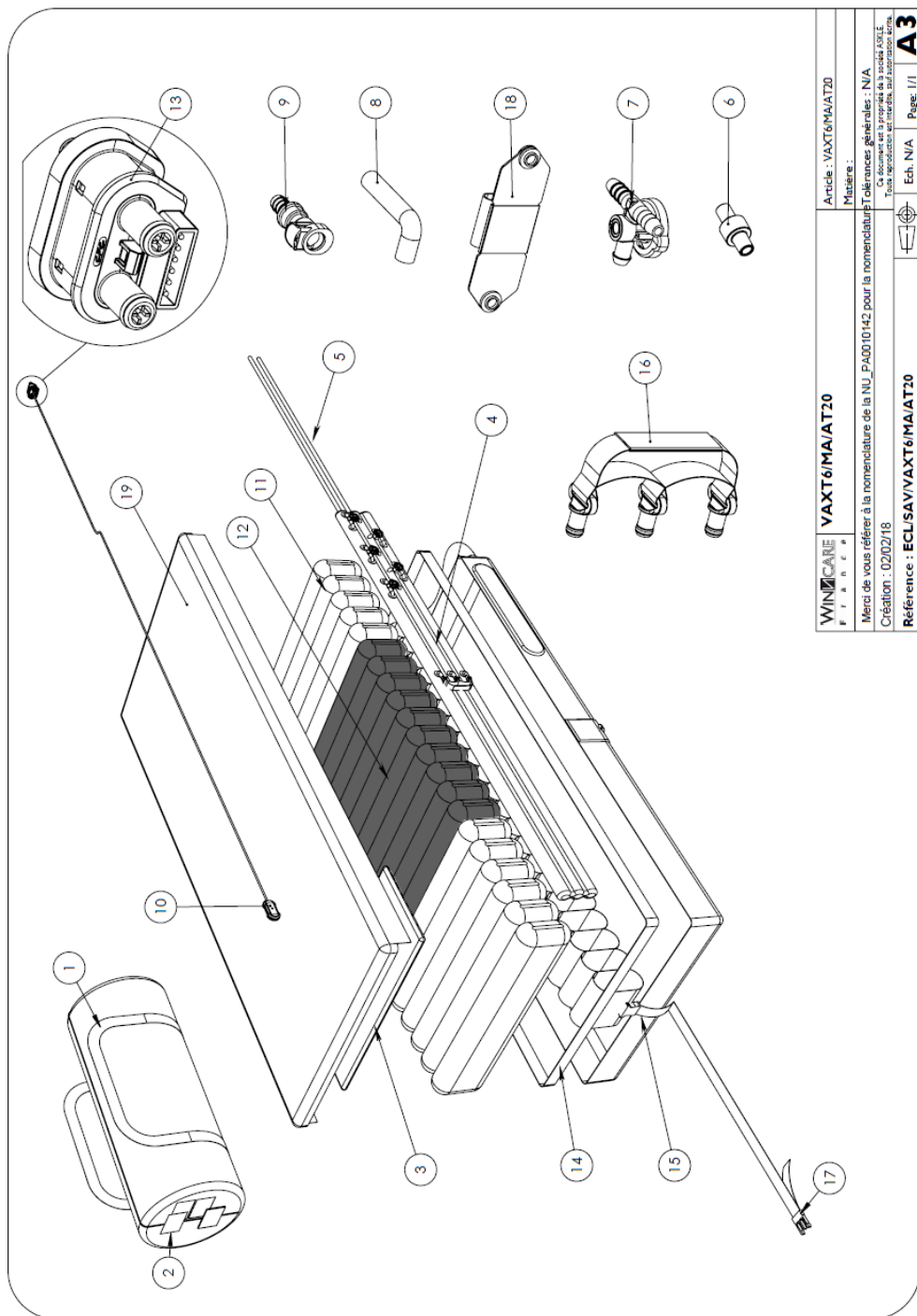

| | | |
|---|----------------------|-------------------------|
| WINNCARE F I A N C E | VAXT6/MA/AT20 | Article : VAXT6/MA/AT20 |
| Merci de vous référer à la nomenclature de la NU_PA001042 pour la nomenclature des pièces générales : N/A | | Matériau : |
| Création : 02/02/18 | | Éch. N/A |
| Référence : ECL/SA/VAXT6/MA/AT20 | | Page: 1/1 |

| Rep. | Reference | Designation |
|------|---------------|--------------------------------------|
| 1 | VAXT/SB | Transport bag |
| 2 | PA0020105 | Dirty/clean label |
| 3 | PB2050497 | Foam head cushion |
| 4 | PB2050418 | Pneumatic harness |
| 5 | PB2040069 | Grey pipe |
| 6 | PB2050285 | Non-return valve + silencer |
| 7 | PB2050531 | Heel discharge valve |
| 8 | PB2050330 | Elbow pipe |
| 9 | PB2050084 | Self-sealing female connector |
| 10 | PB2050182 | Hybrid male coupler + Axensor sensor |
| 11 | PB2050434 | Axensor cell ype 1 |
| 12 | PB2050435 | Axensor cell ype 2 |
| 13 | PB2050162* | Hybrid male coupler |
| 14 | PB2050326 | Holding sheet |
| 15 | PB2050332 | AT20 base |
| 16 | PB2050352 | CPR handle |
| 17 | PB2050093 | Built-in buckle 38 mm |
| 18 | PB2050333 | Axensor box support |
| 19 | VHCIC/AXT90-H | CIC top cover |

*the use of these references requires the AirCare training

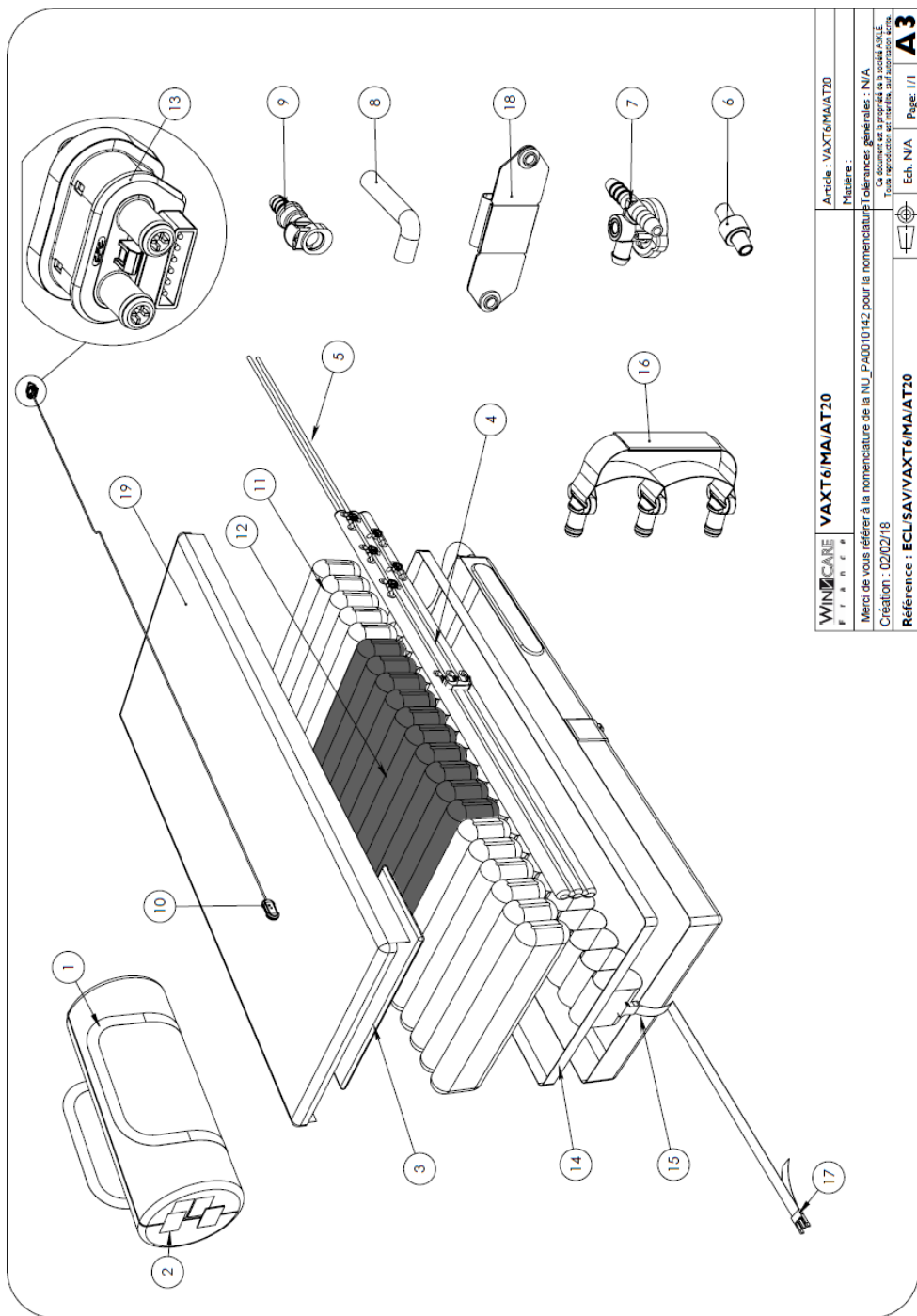

| | | |
|---|---------------|-------------------------|
| WINNCARE | VAXT6/MA/AT20 | Article : VAXT6/MA/AT20 |
| F I L I A R E # | | Matériau : |
| Merci de vous référer à la nomenclature de la NU_PA0010142 pour la nomenclature et tolérances générales : N/A | | |
| Création : 02/02/18 | | |
| Tous droits réservés. Toute réimpression est interdite, sans autorisation écrite. | | |
| Référence : ECLISAV/VAXT6/MA/AT20 | | Ech. N/A Page: 1/1 |
| | | A3 |

List of references: VAXT6/MA/AT20-80

| Rep. | Référence | Désignation |
|------|------------------|--------------------------------------|
| 1 | VAXT/SB | Transport bag |
| 2 | PA0020105 | Dirty/clean label |
| 3 | PB2050497 | Foam head cushion |
| 4 | PB2050418 | Pneumatic harness |
| 5 | PB2050231 | Tuyau Cristal 8,3x14,3 L1200mm |
| 6 | PB2050285 | Non-return valve + silencer |
| 7 | PB2050531 | Heel discharge valve |
| 8 | PB2050330 | Elbow pipe |
| 9 | PB2050084 | Self-sealing female connector |
| 10 | PB2050182 | Hybrid male coupler + Axensor sensor |
| 11 | PB2050368 | Axensor cell type 1 |
| 12 | PB2050369 | Axensor cell type 2 |
| 13 | PB2050162* | Hybrid male coupler |
| 14 | PB2050396 | Holding sheet AT20-80 |
| 15 | PB2050397 | AT20-80 base |
| 16 | PB2050352 | CPR handle |
| 17 | PB2050093 | Built-in buckle 38 mm |
| 18 | PB2050333 | Axensor box support |
| 19 | VHCIC/AXT80/HAUT | CIC top cover |

*the use of these references requires the AirCare training

AXTAIR XXL MATTRESS - REFERENCE VAXT/MA/120XXL

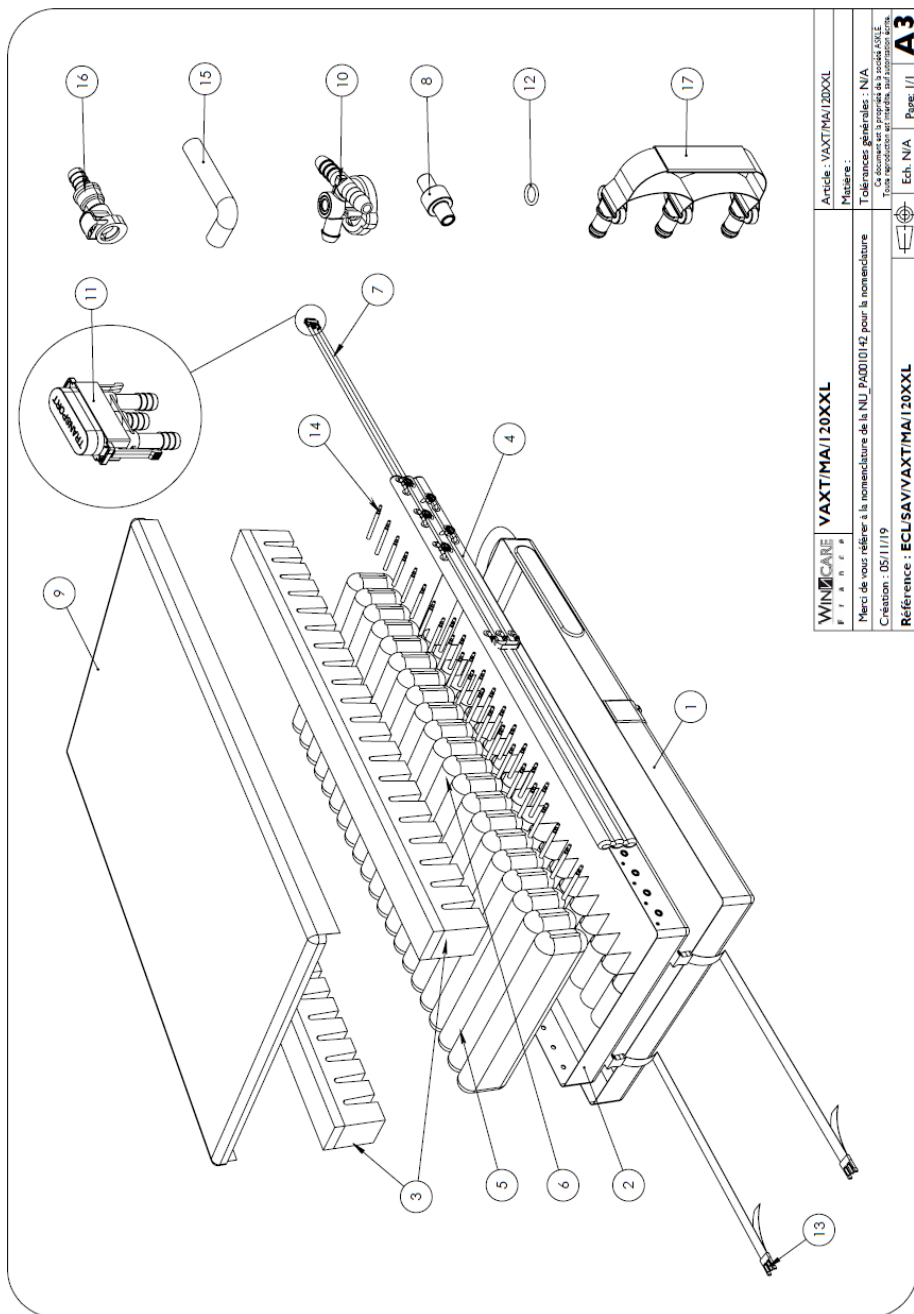

| | | |
|--------------------------------|--|--|
| WINNCARE F I N E R E | VAXT/MA/120XXL | Article : VAXT/MA/120XXL |
| | Marc de votre référer à la nomenclature de la NU_PAD01042 pour la nomenclature | Matière : |
| | Création : 05/11/19 | Tolérances générales: N/A Ce document est la propriété de la société WINNCARE. Toute réimpression est interdite, sauf autorisation écrite. |
| | Reference : ECL/SAV/VAXT/MA/120XXL | Ech. N/A Page: 1/1 A3 |

List of references: VAXT/MA/120XXL

| Rep. | Références | Désignation |
|------|-------------------------|-----------------------------------|
| 1 | PB2050360 | XXL120 base cover |
| 2 | PB2050361 | inside cover XXL |
| 3 | PA9030085 | Foam Stabilizing Edge 120 XXL |
| 4 | PB2050418 | Pneumatic harness |
| 5 | Selon numéro de serie** | Axensor cell type 1 |
| 6 | Selon numéro de serie** | Axensor cell type 2 |
| 7 | PB2040069 | Grey pipe |
| 8 | PB2050285 | Non-return valve + silencer |
| 9 | VHPH/AXT120-H | Top cover Axtair 120 PUHD |
| 10 | PB2050531 | Heel discharge valve |
| 11 | PB2050213 | Complete male pneumatic connector |
| 12 | PB0050026 | O-ring for male connector |
| 13 | PB2050093 | Built-in buckle 38 mm |
| 14 | PB2050386 | Extension XXL 120 tube-connector |
| 15 | PB2050330 | Elbow pipe |
| 16 | PB2050084 | Auto Female Connector. |
| 17 | PB2050352 | CPR handle kit |

** Please contact our service department with your mattress serial number

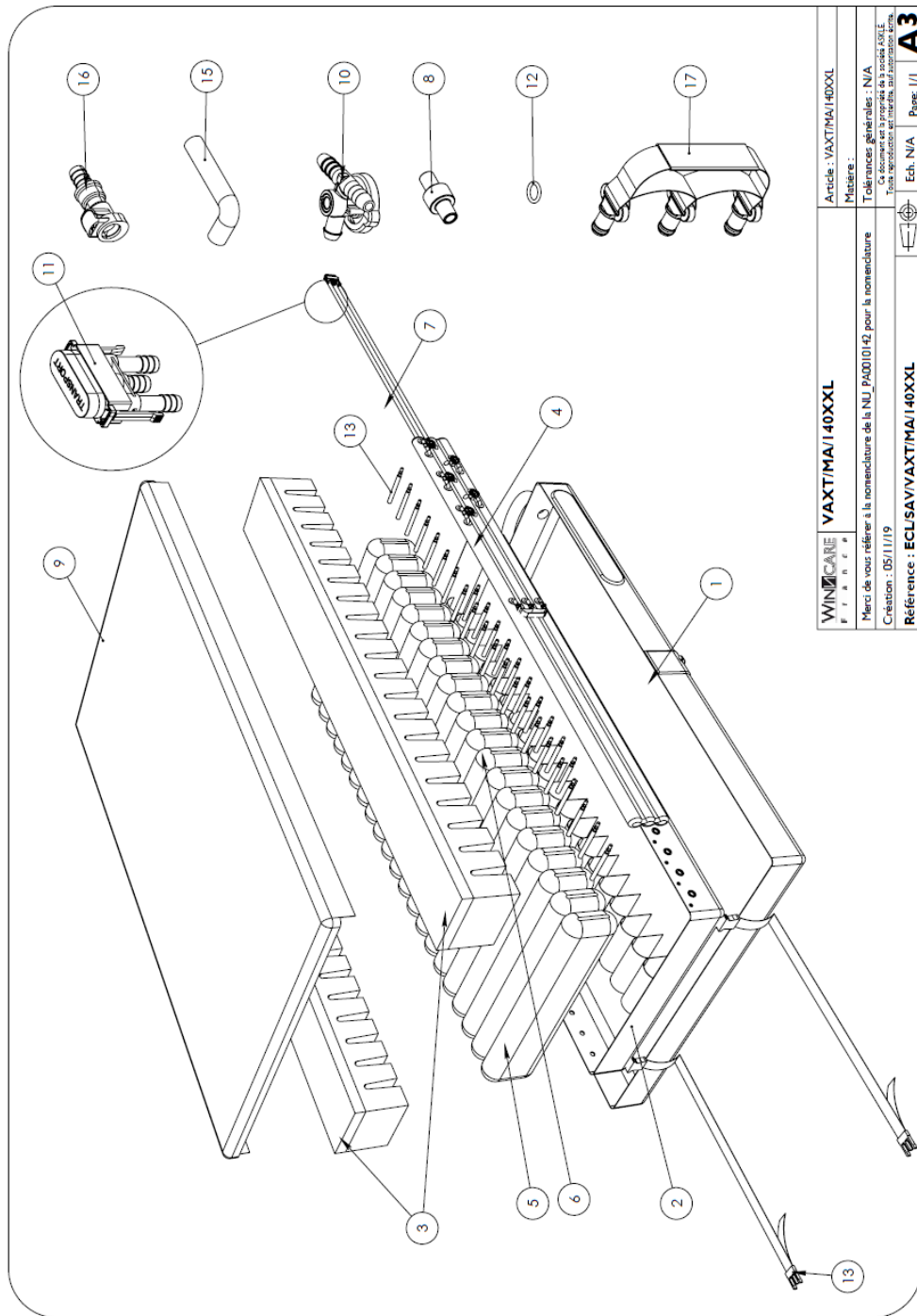

| | | |
|--|----------------|----------------------------|
| WINNOCARE F. I. M. O. S. | VAXT/MA/140XXL | Article : VAXT/MA/140XXL |
| Merci de vous référer à la nomenclature de la NUJ_P40010142 pour la nomenclature | | Tolérances générales : N/A |
| Création : 05/11/19 | | Edt. N/A |
| Référence : ECLUSA/VAXT/MA/140XXL | | Page: 1/1 |

List of references: VAXT/MA/140XXL

| Rep. | Références | Désignation |
|------|-------------------------|-----------------------------------|
| 1 | PB2050365 | XXL140 base cover |
| 2 | PB2050361 | inside cover XXL |
| 3 | PA9030086 | Foam Stabilizing Edge 140 XXL |
| 4 | PB2050418 | Pneumatic harness |
| 5 | Selon numéro de serie** | Axensor cell type 1 |
| 6 | Selon numéro de serie** | Axensor cell type 2 |
| 7 | PB2040069 | Grey pipe |
| 8 | PB2050285 | Non-return valve + silencer |
| 9 | VHPH/AXT140-H | Top cover Axtair 120 PUHD |
| 10 | PB2050531 | Heel discharge valve |
| 11 | PB2050213 | Complete male pneumatic connector |
| 12 | PB0050026 | O-ring for male connector |
| 13 | PB2050093 | Built-in buckle 38 mm |
| 14 | PB2050387 | Extension XXL 140 tube-connector |
| 15 | PB2050330 | Elbow pipe |
| 16 | PB2050084 | Auto Female Connector. |
| 17 | PB2050352 | CPR handle kit |

** Please contact our service department with your mattress serial number



WINNCARE France
4, Le Pas du Château
85670 SAINT-PAUL-MONT-PENIT
FRANCE



WINNCARE France
200 Rue Charles Tellier
30000 NIMES
FRANCE



Tél. : +33 (0)4.66.02.15.15
Fax. : +33 (0)4.66.02.15.00
Email: contact@winncafe.fr
www.winncafe.com